

Installation Manual

PART NUMBER(S)	Model Year
TESS 1520 SE	Renault Alaskan
Cab(s)	Installation Time / Weight
Double Cab	40-60 minutes / 53-57 kg

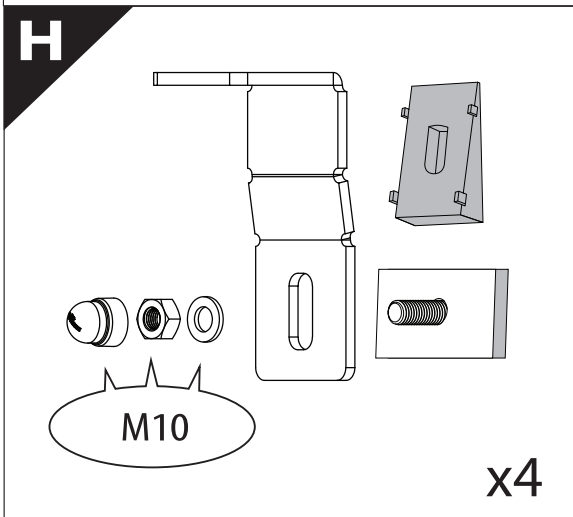

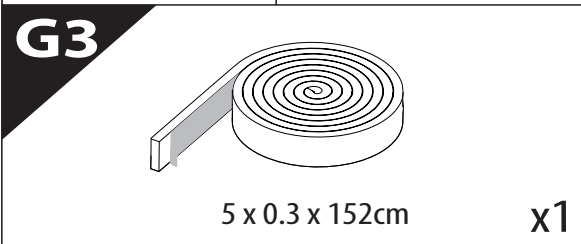
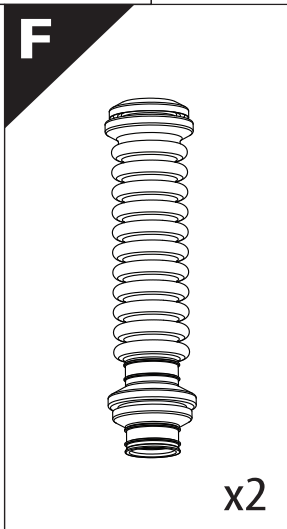
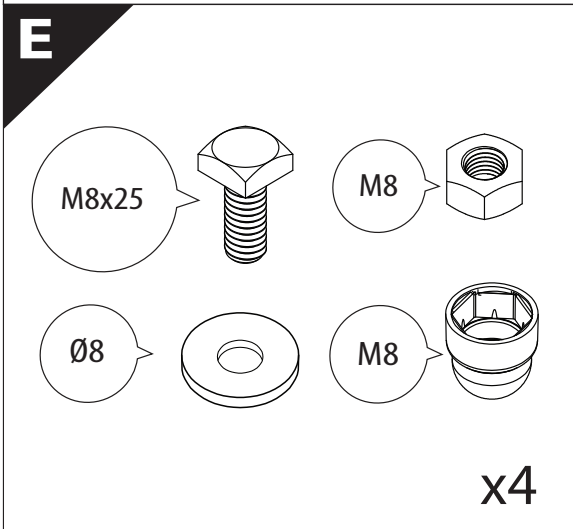
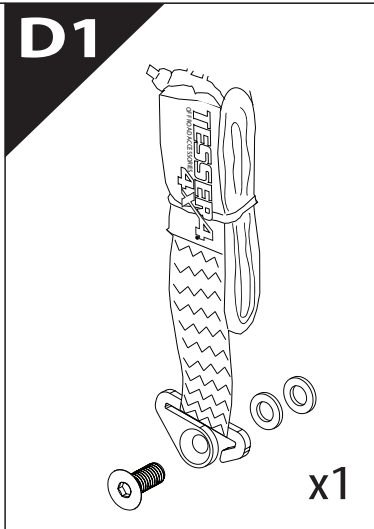
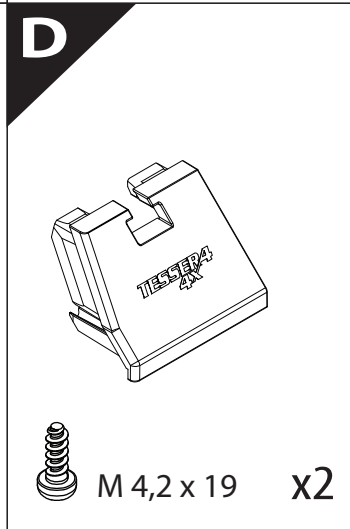
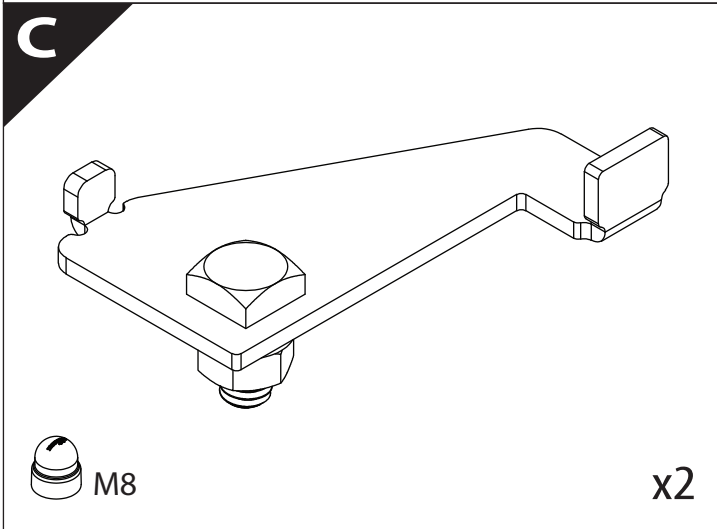
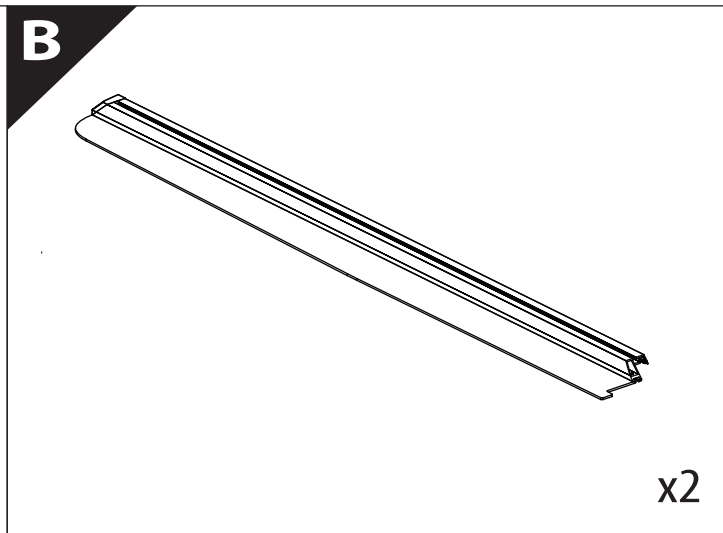
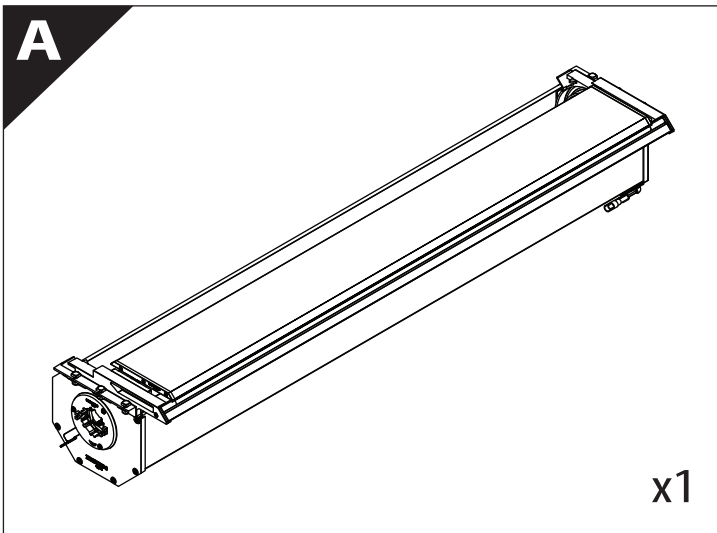
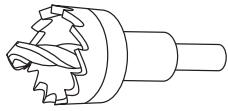

Ø 25 mm / Ø 40 mm

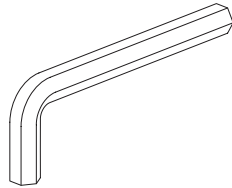
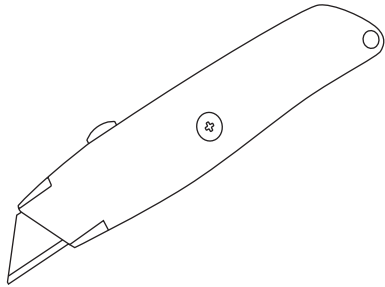
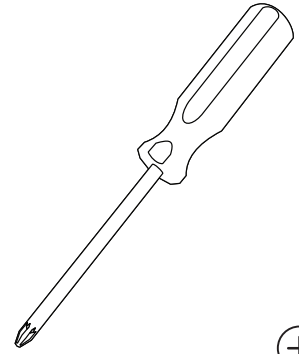
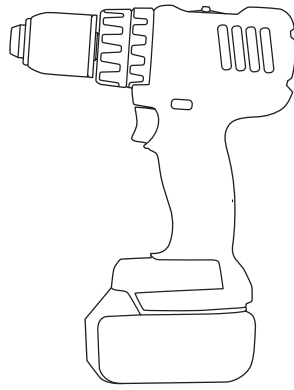

4 mm

1 - 25 Nm

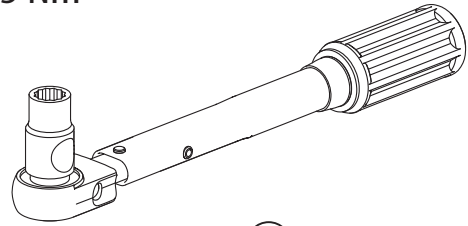

13, 17 mm



ACETONE

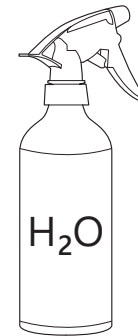
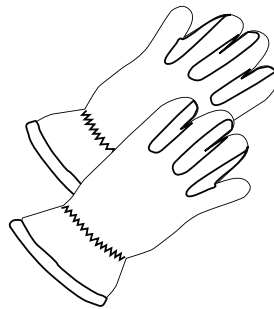
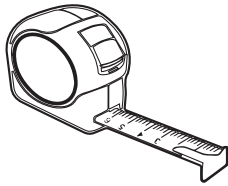

H₂O

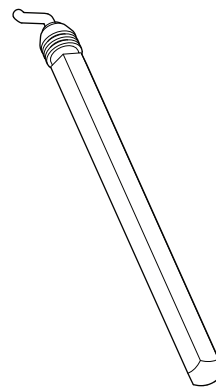
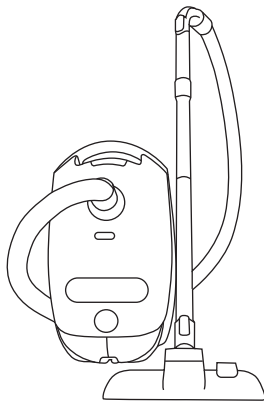
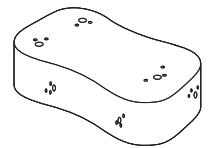

ANTI-RUST



INSTALLATION
MANUAL

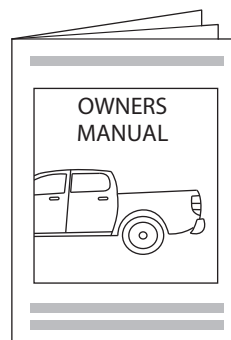

OWNERS
MANUAL

x1

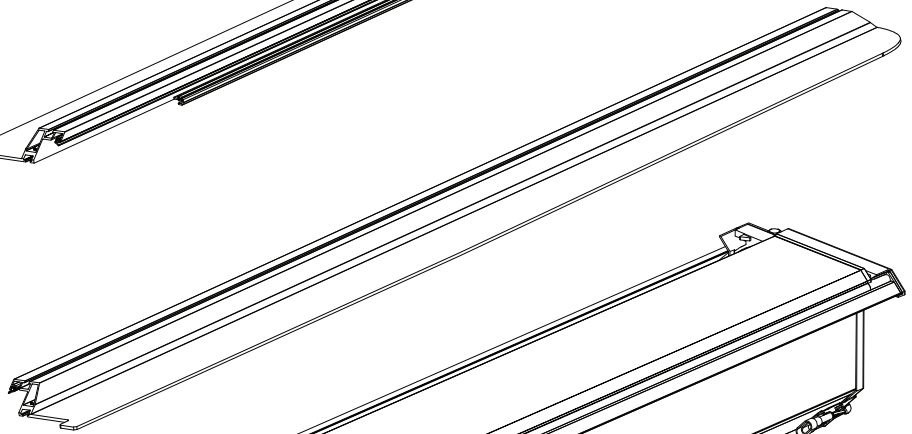
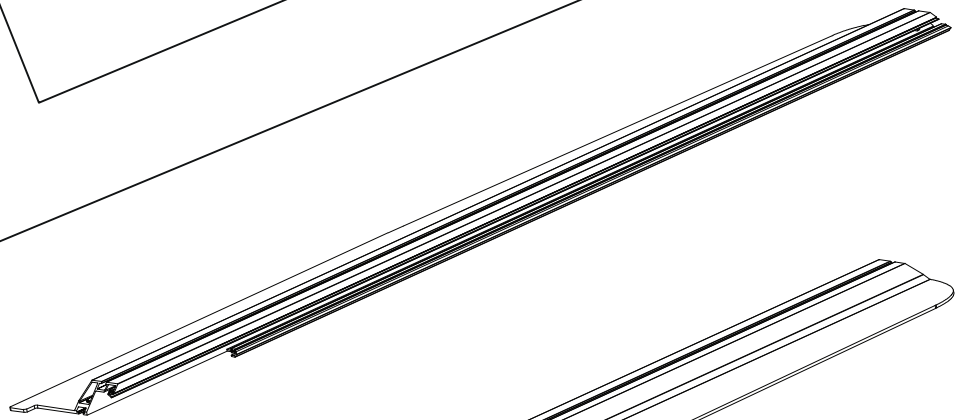
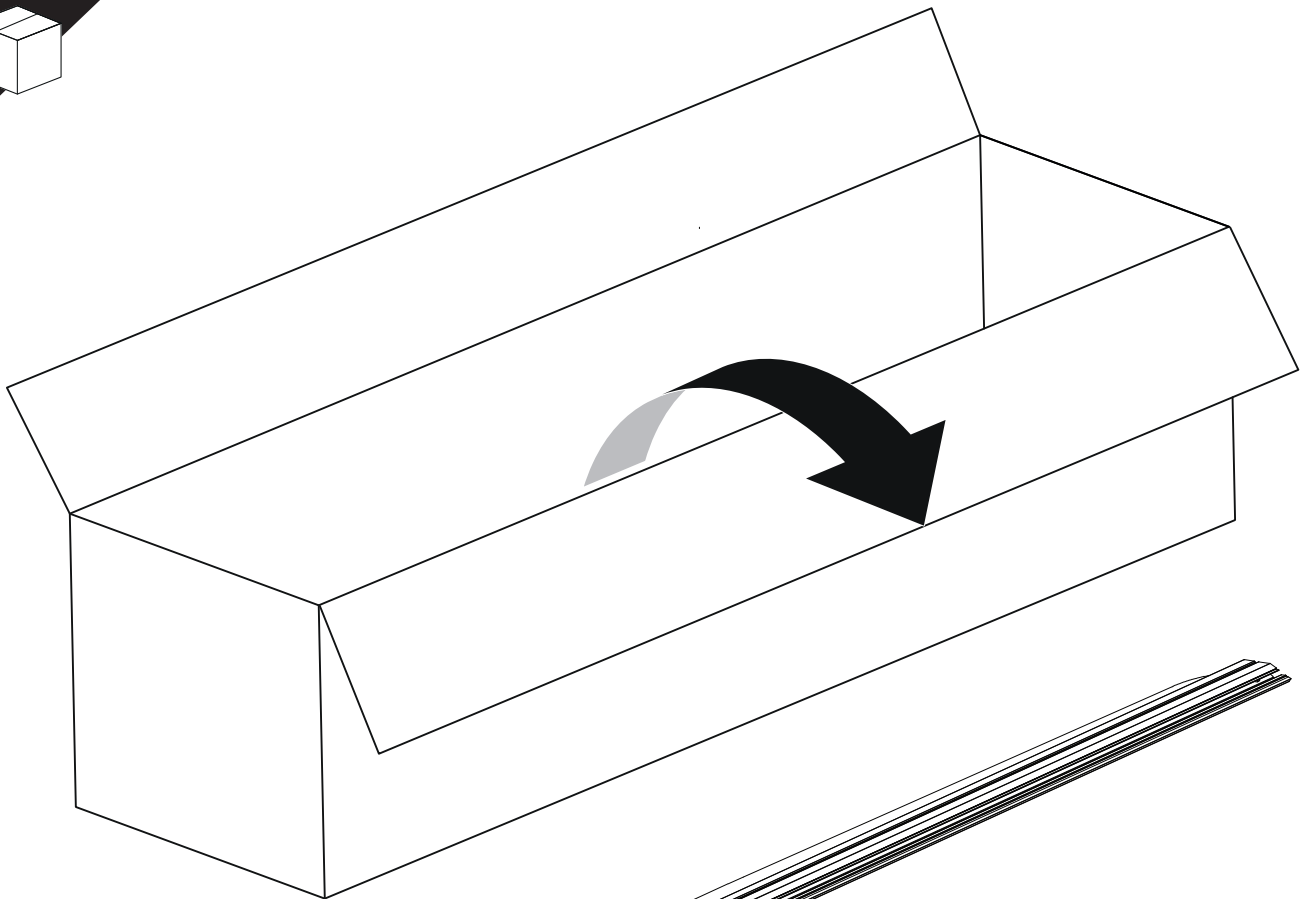

B

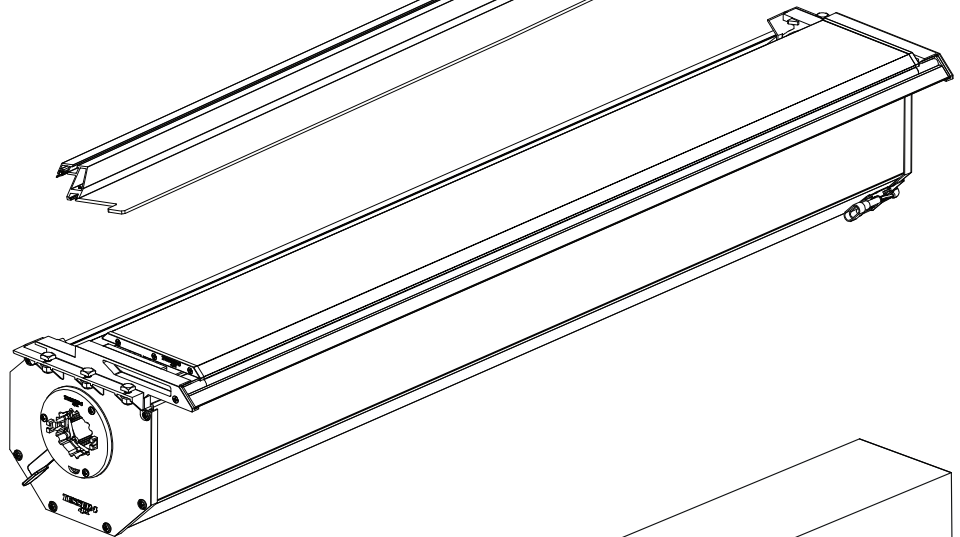

A

KITS

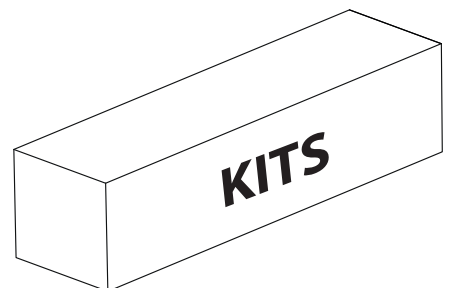

G

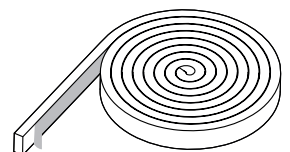

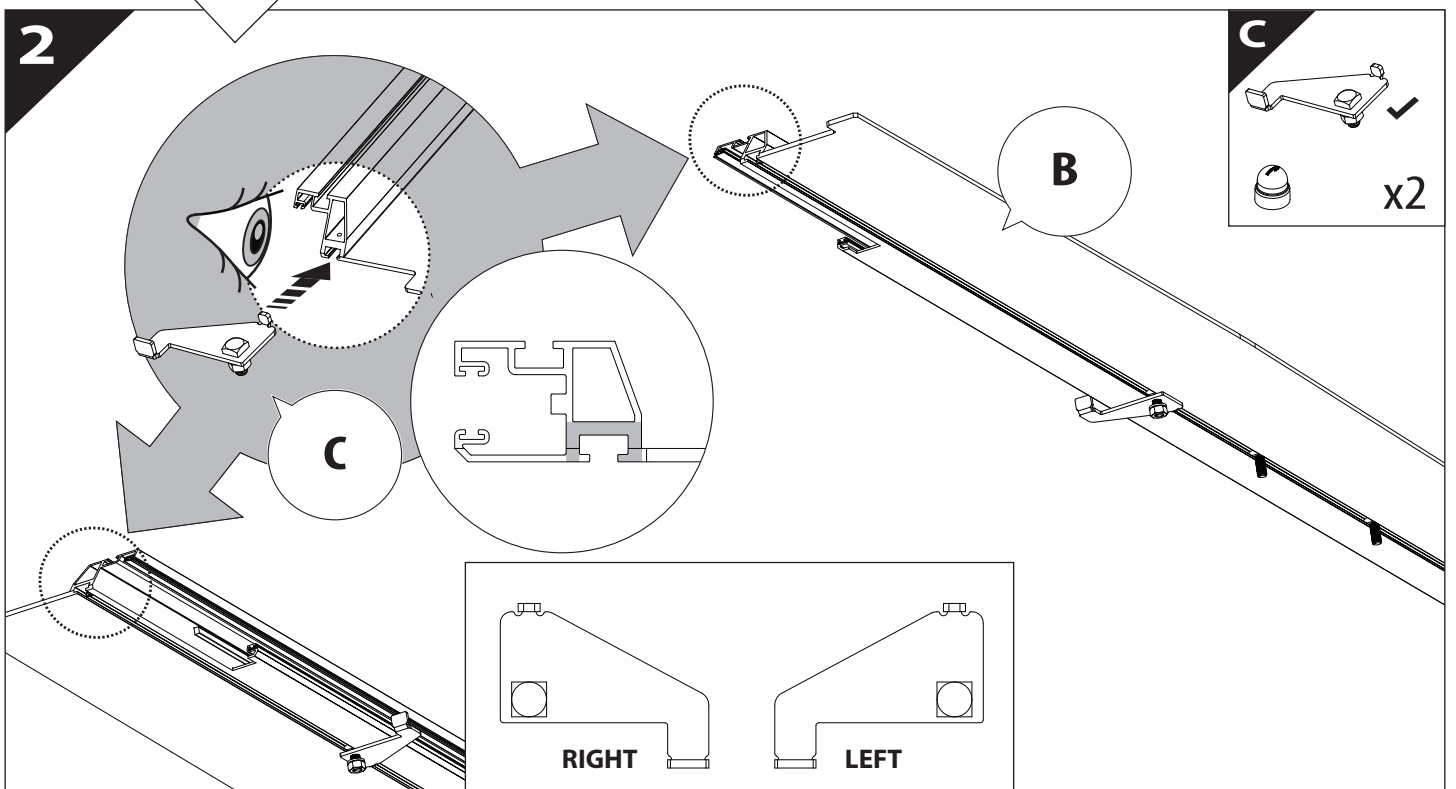
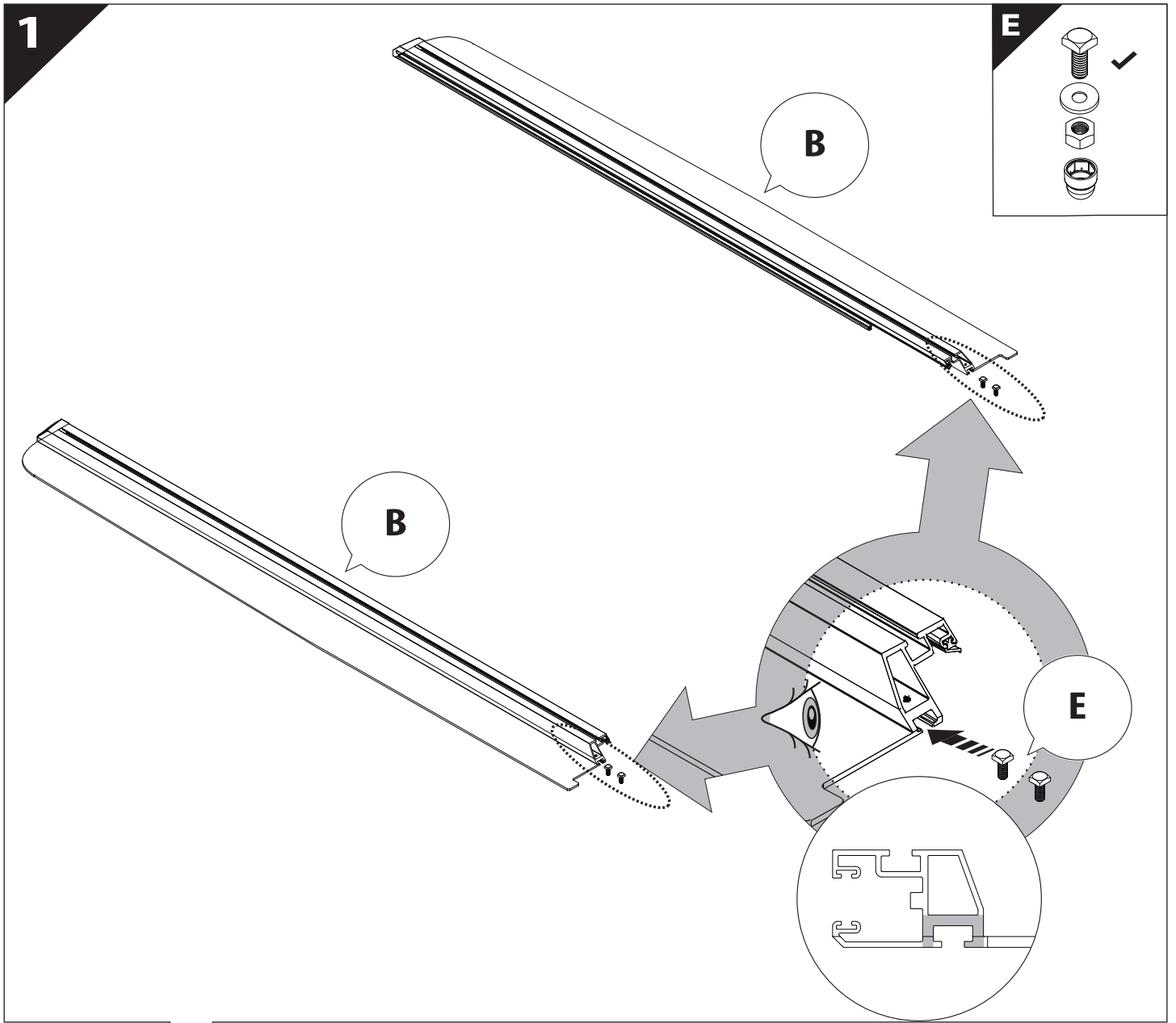

3

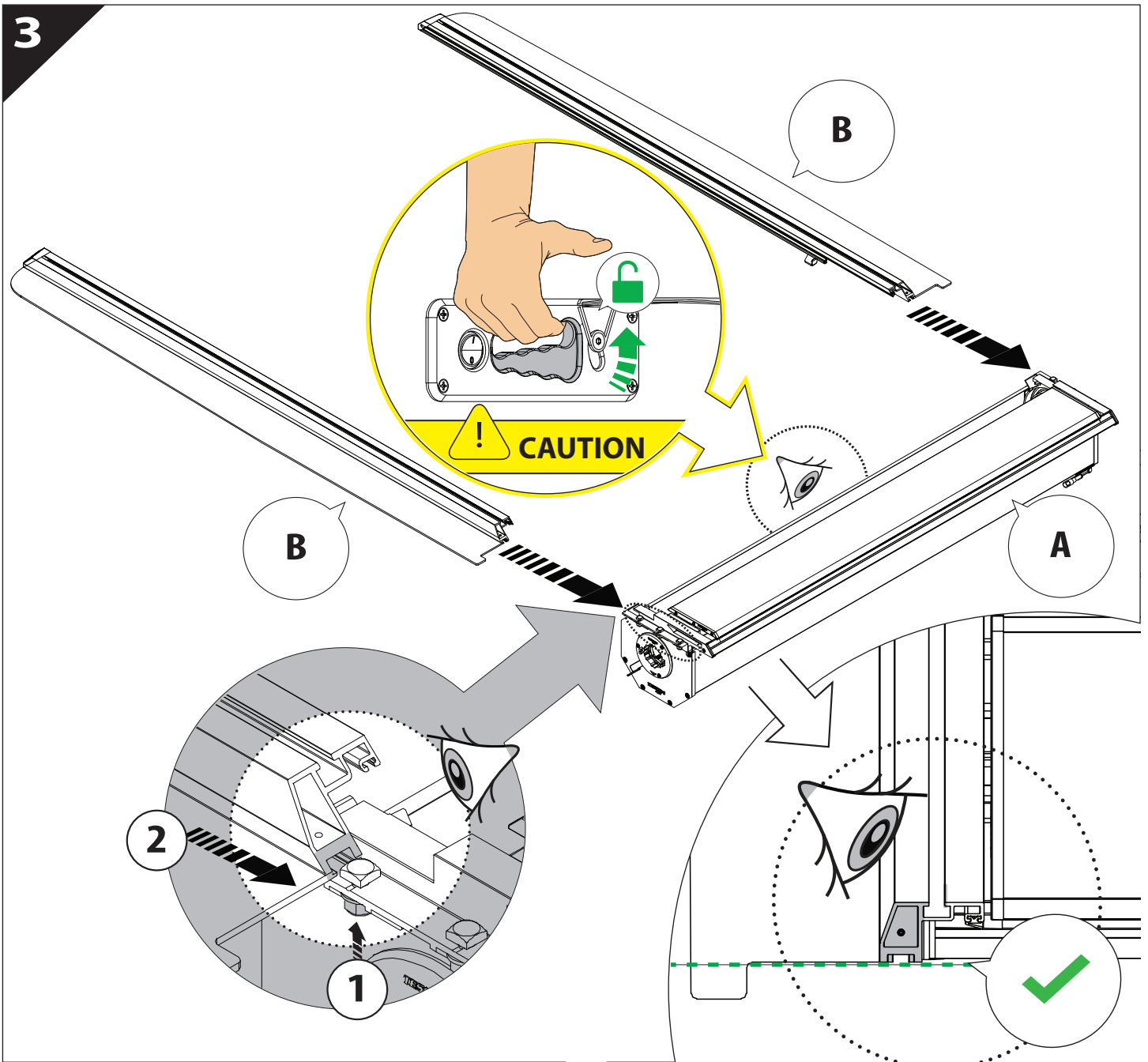

4

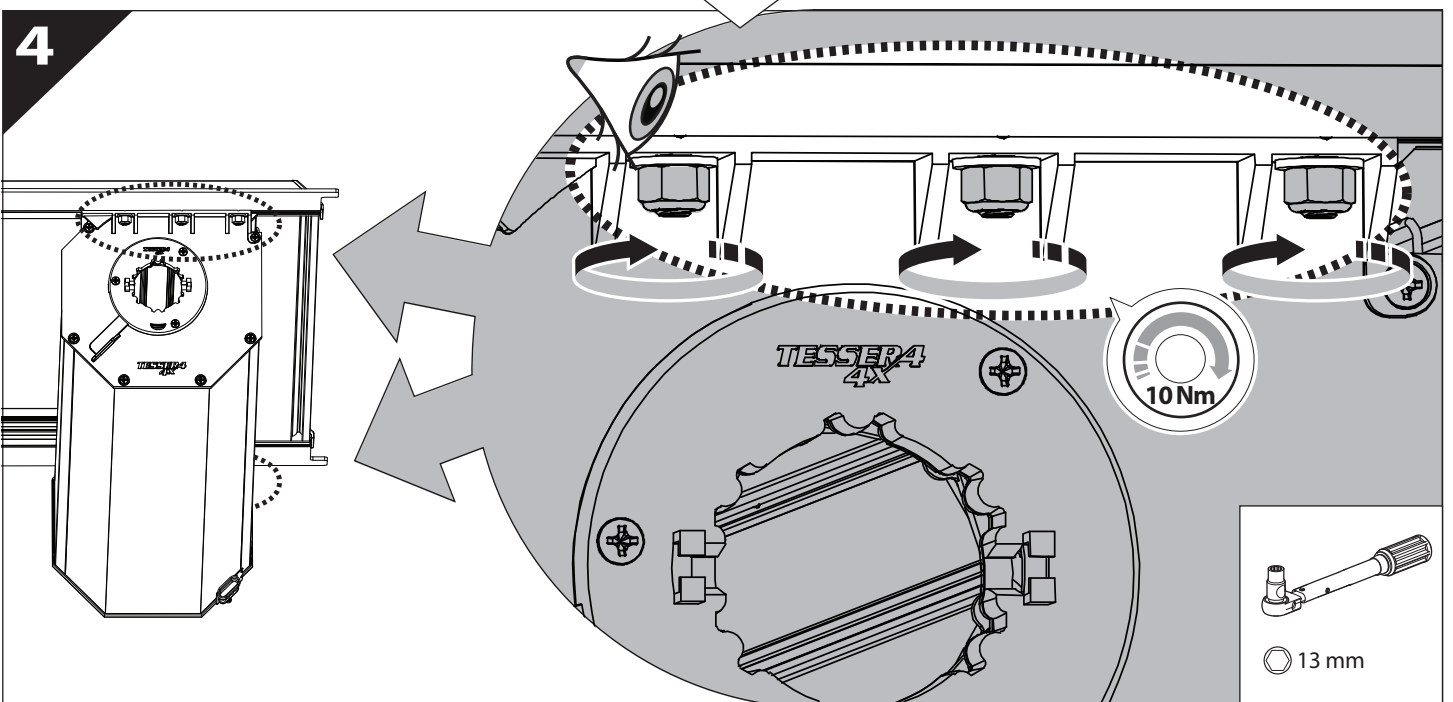

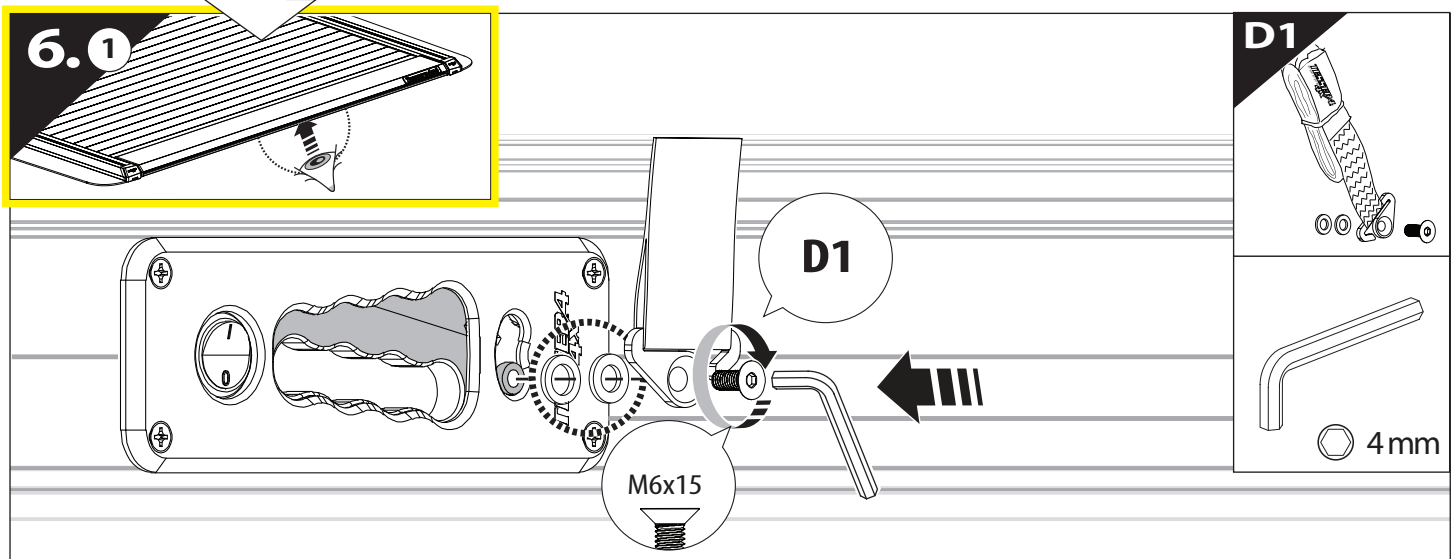
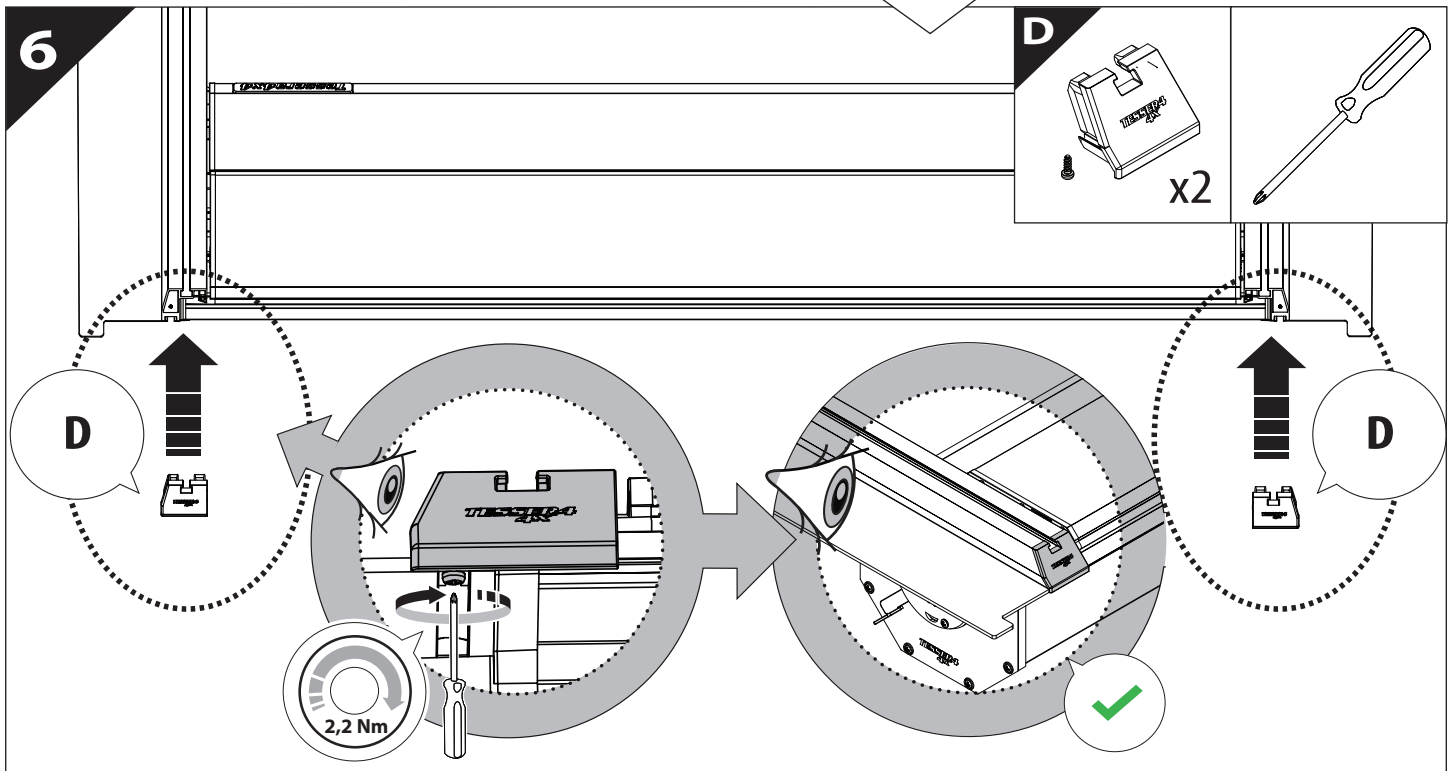
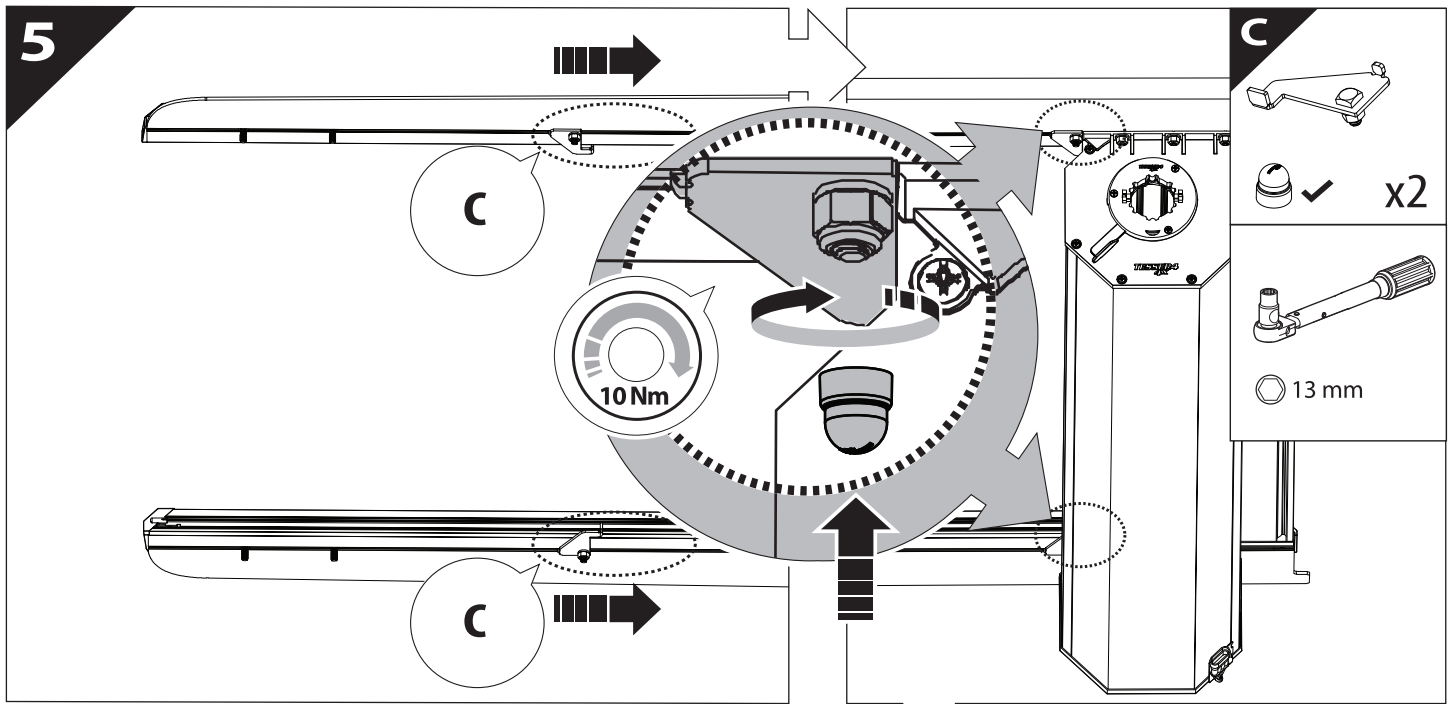

7

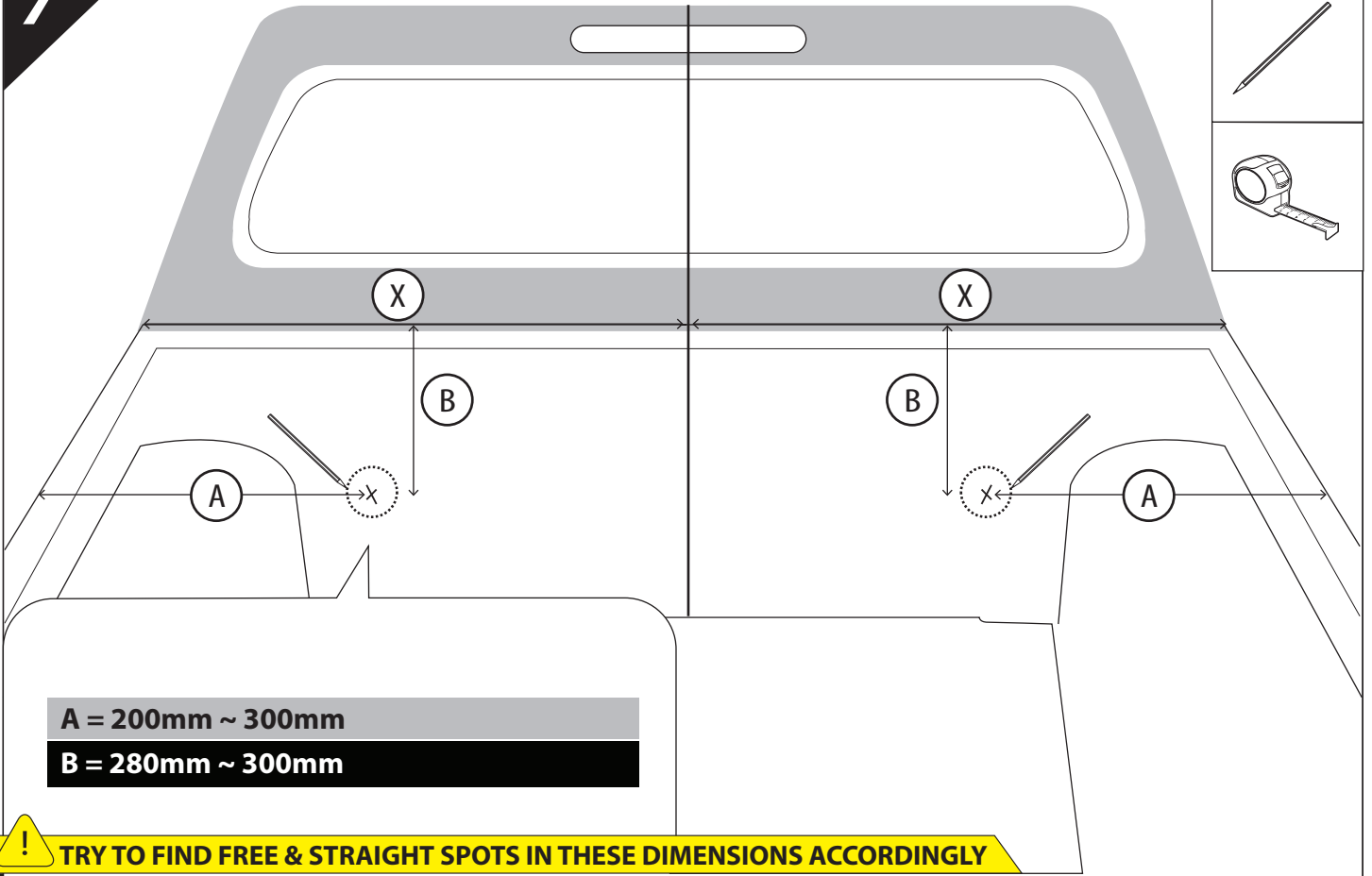
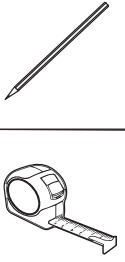

A = 200mm ~ 300mm

B = 280mm ~ 300mm

! TRY TO FIND FREE & STRAIGHT SPOTS IN THESE DIMENSIONS ACCORDINGLY

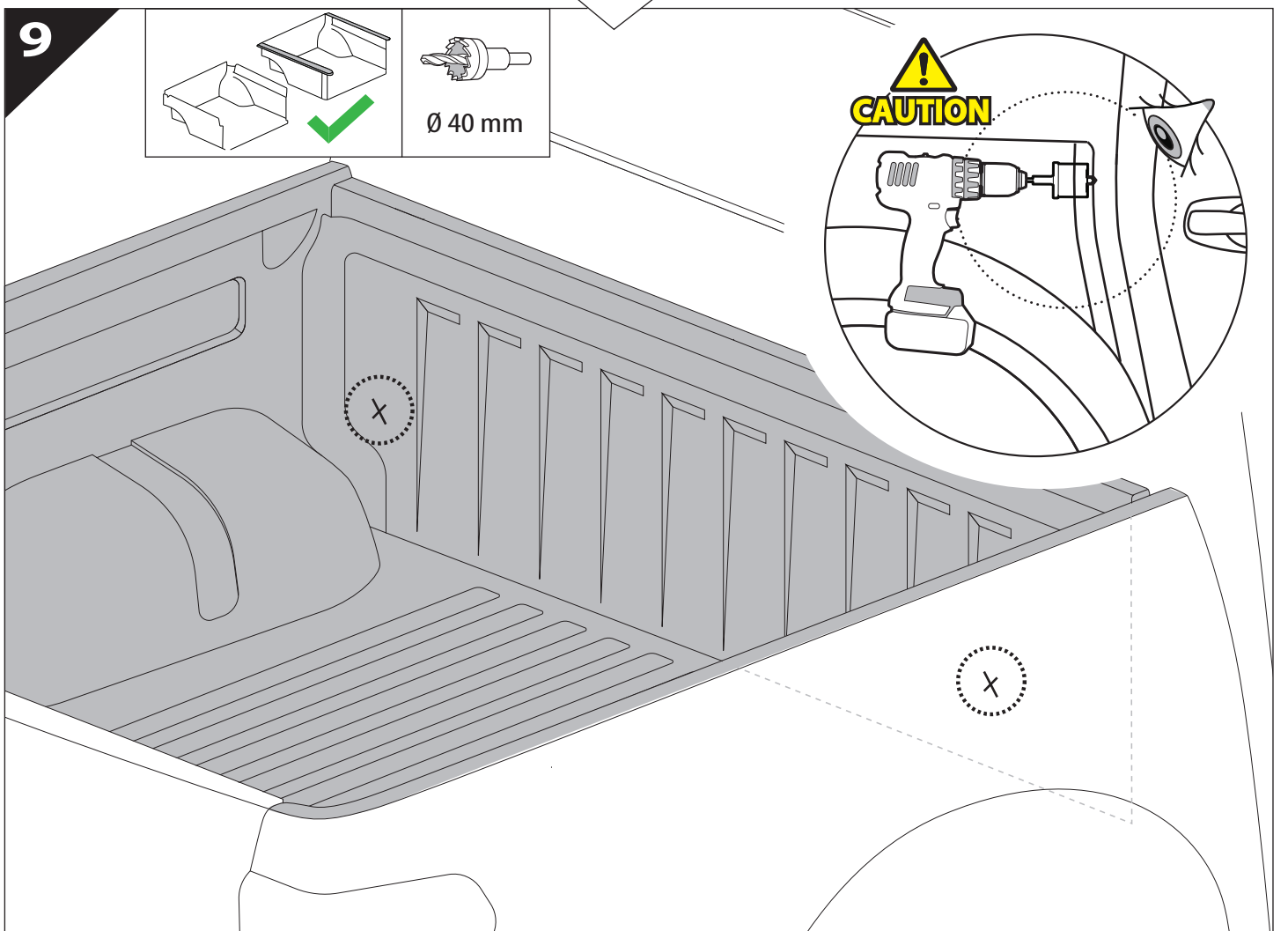
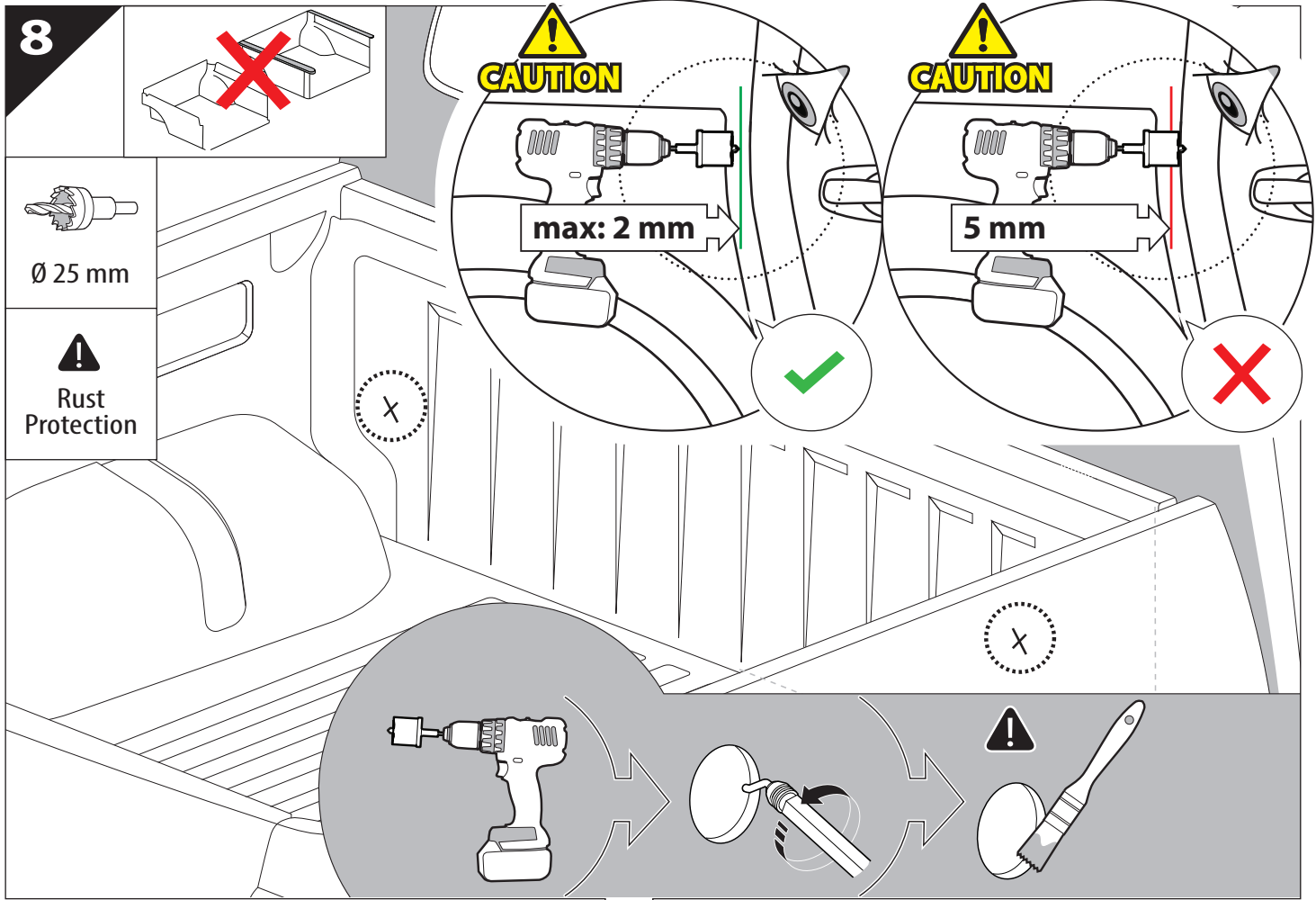

10

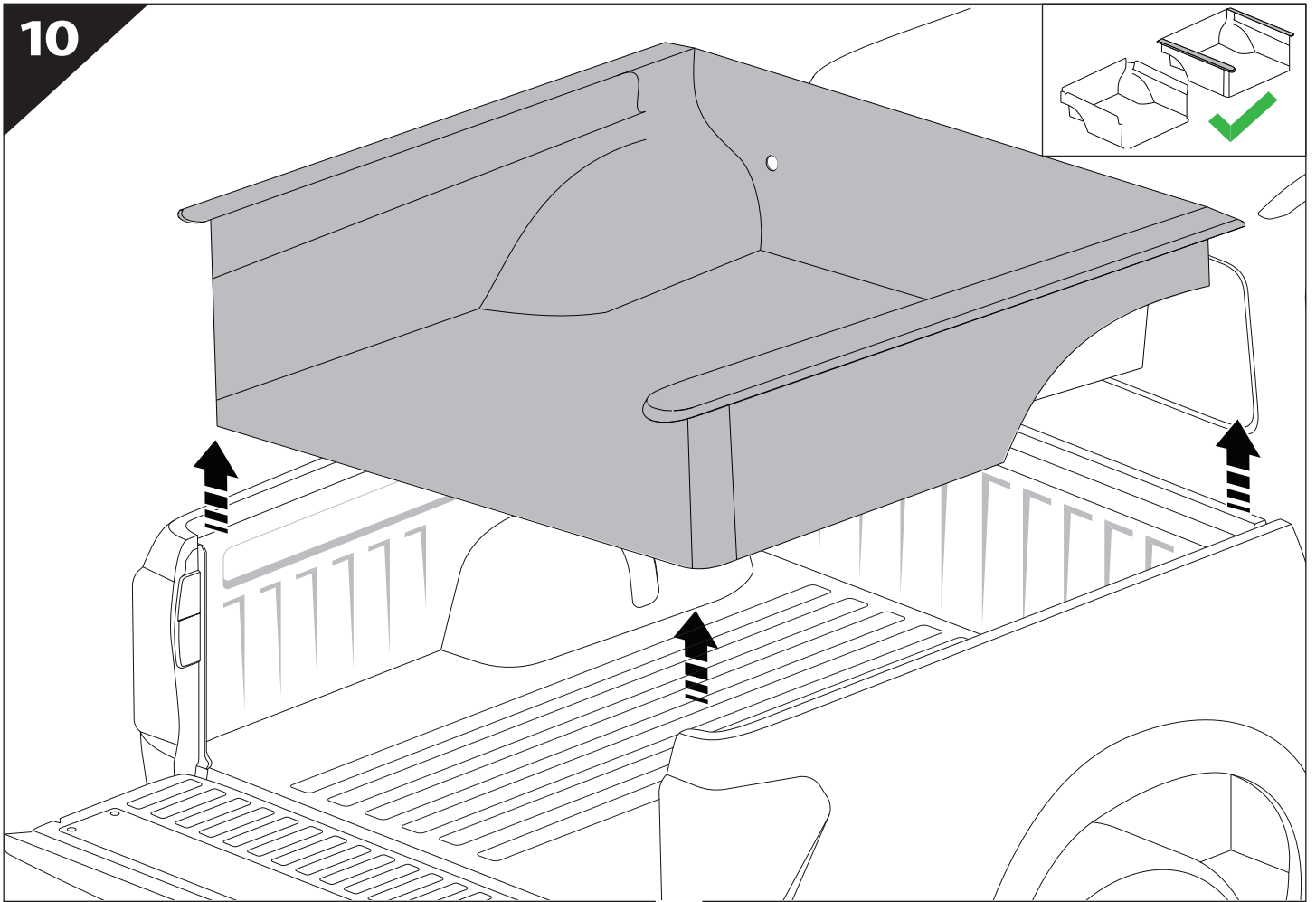

11

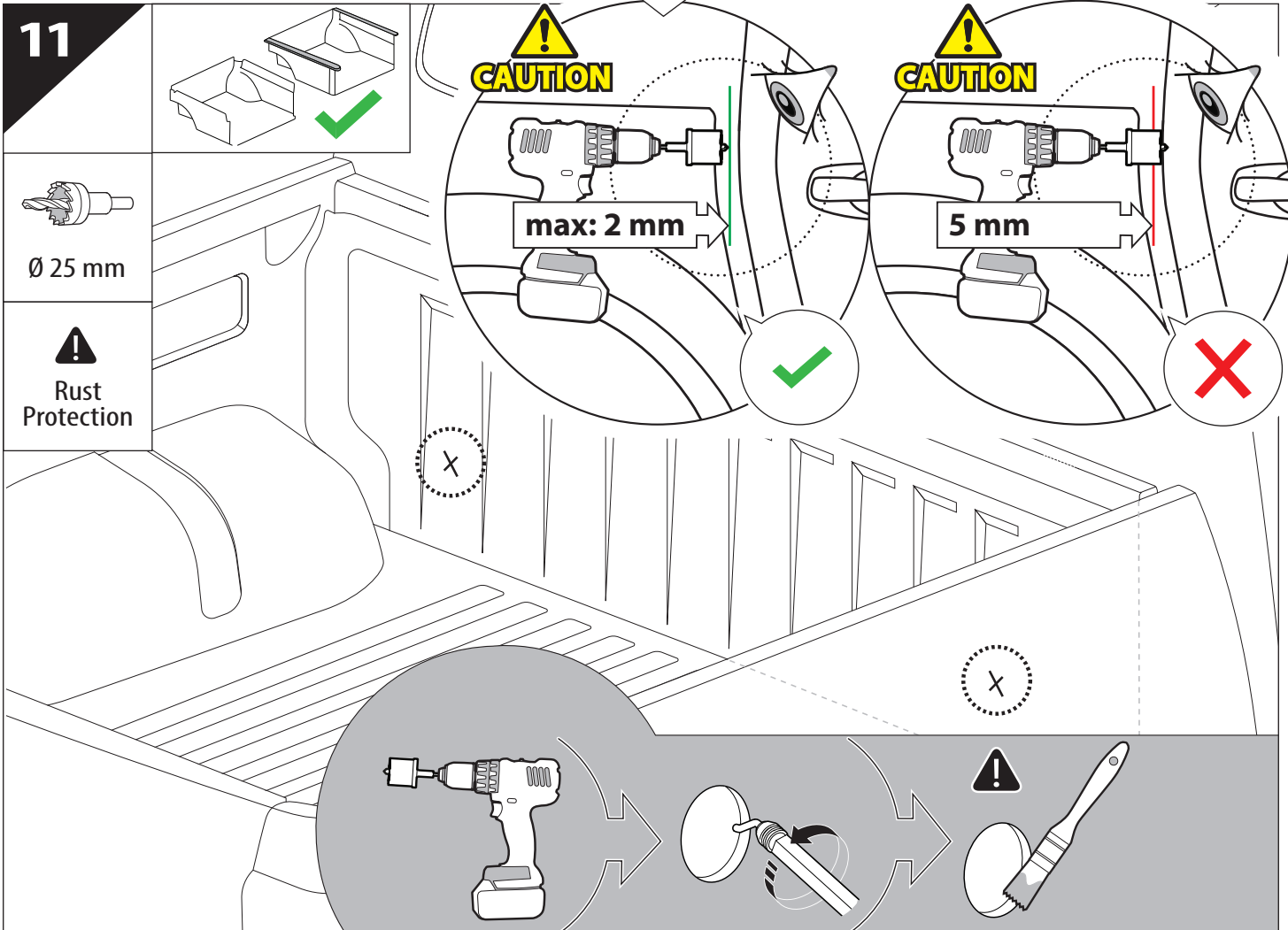

12

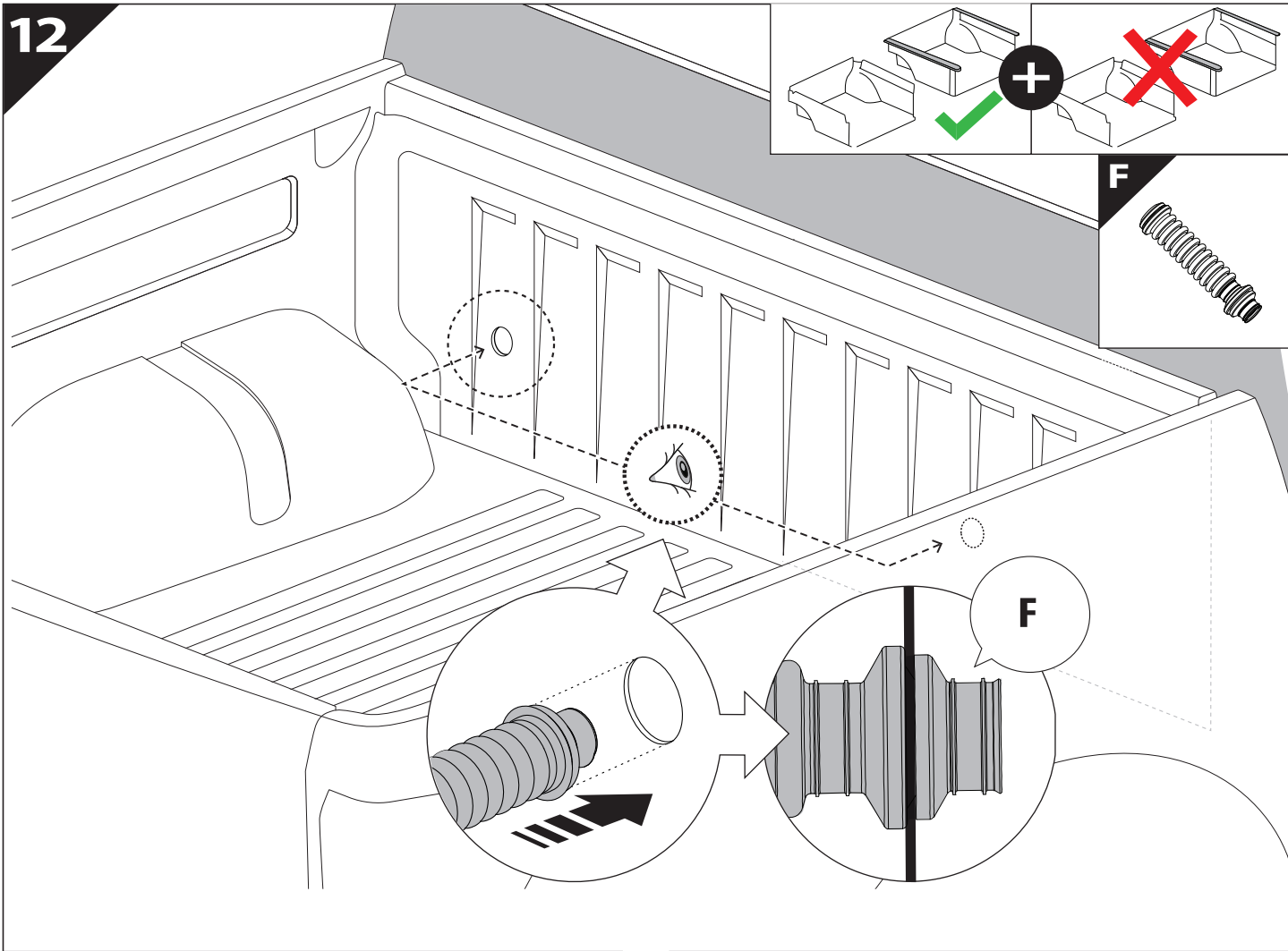

13

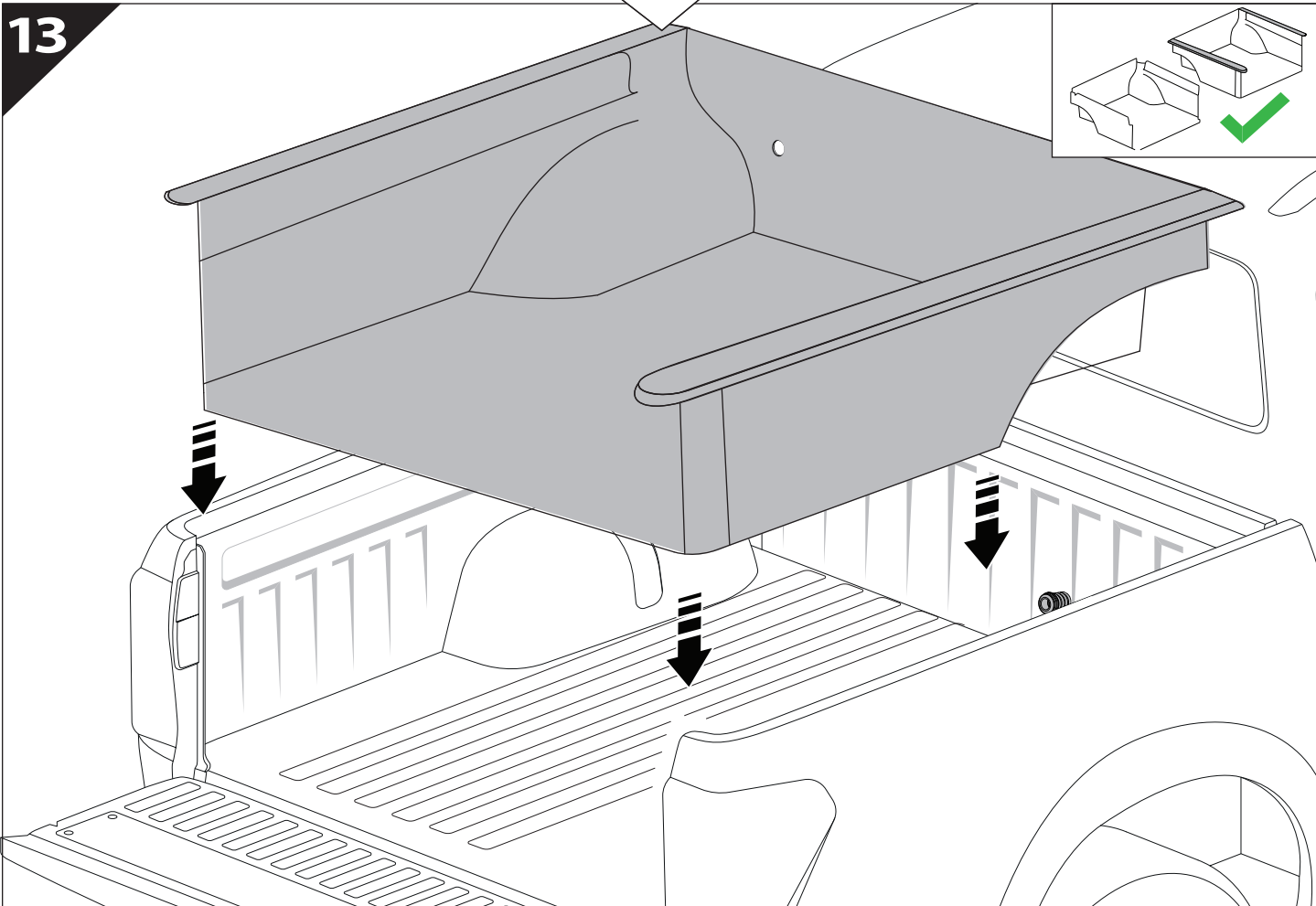

14

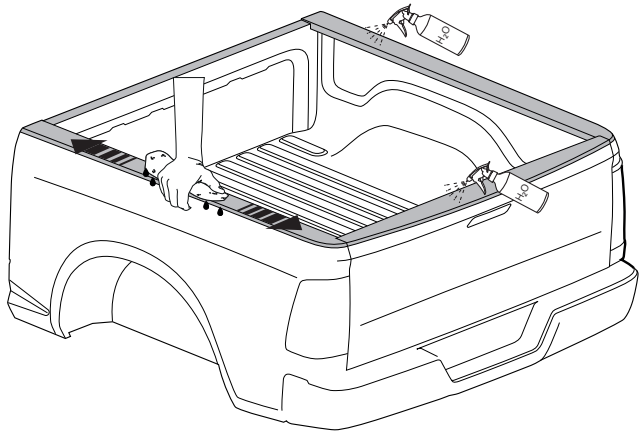
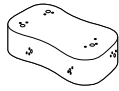
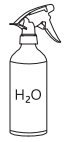

15

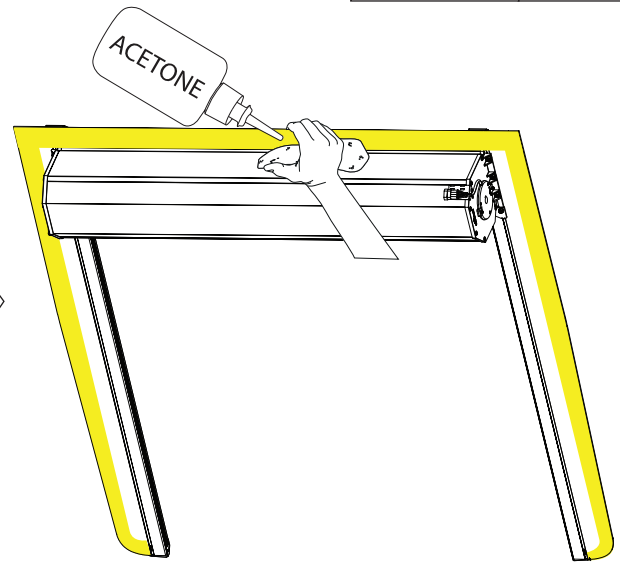

16

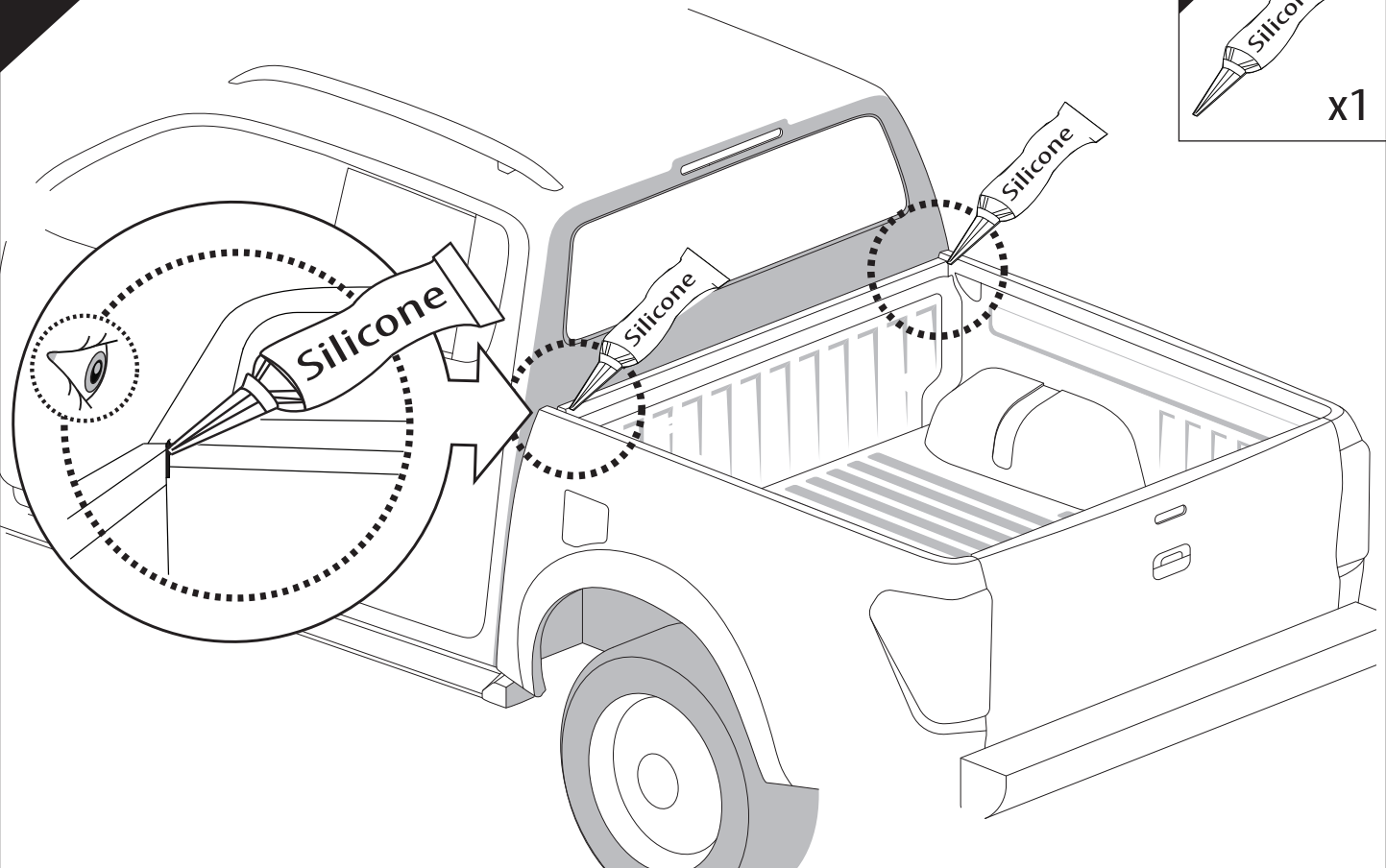

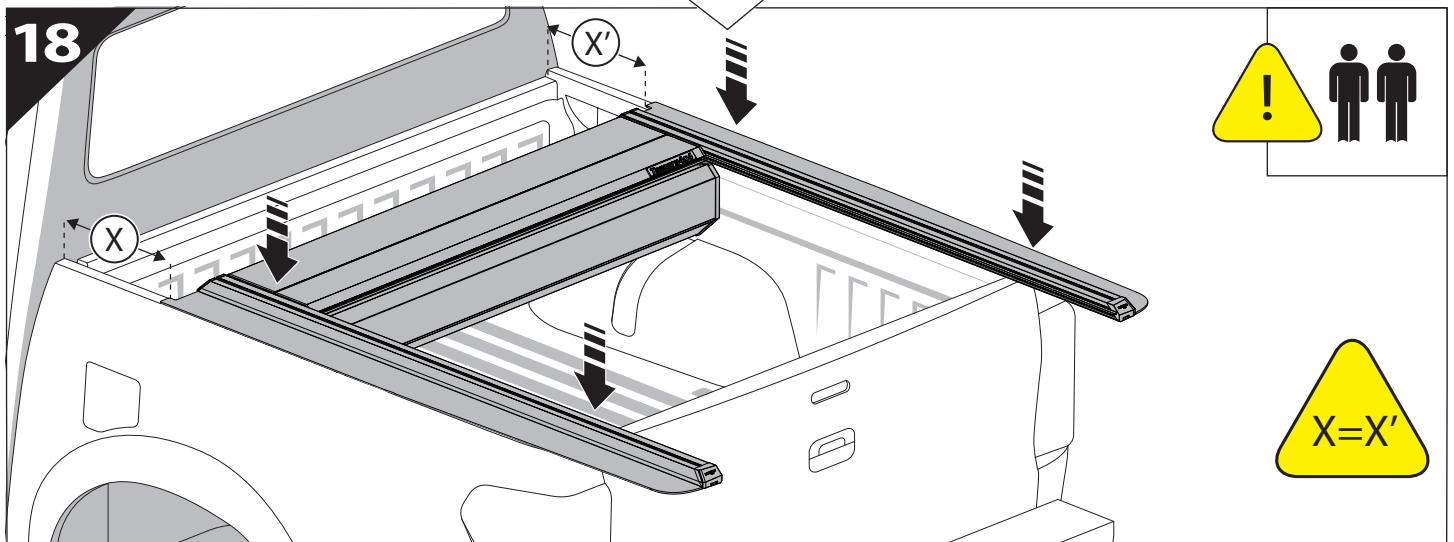
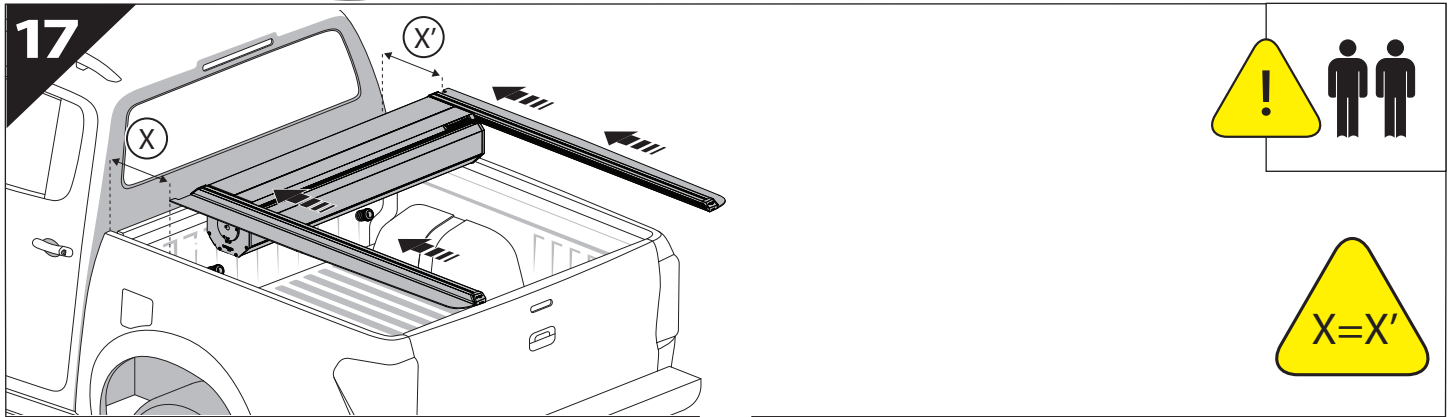
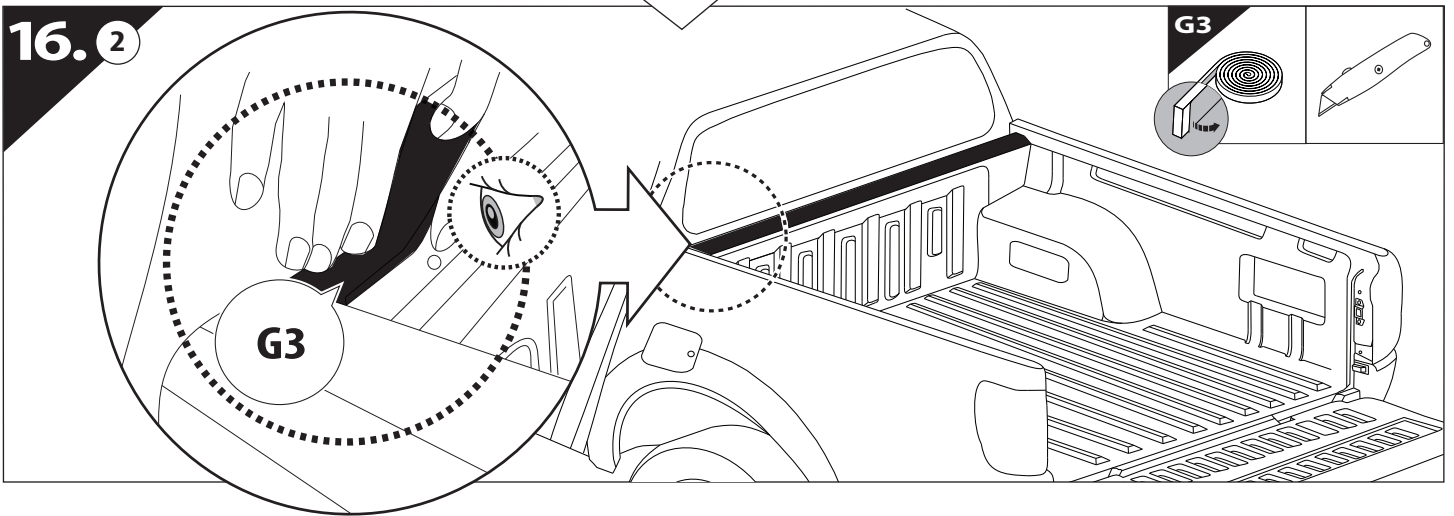
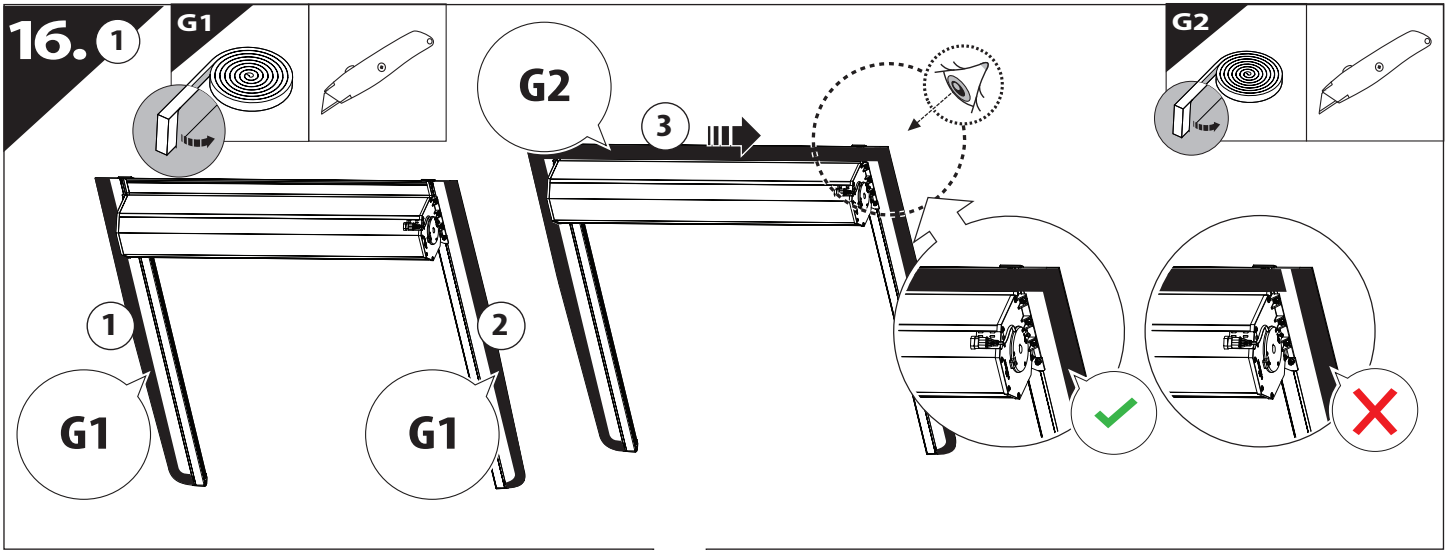

19

F

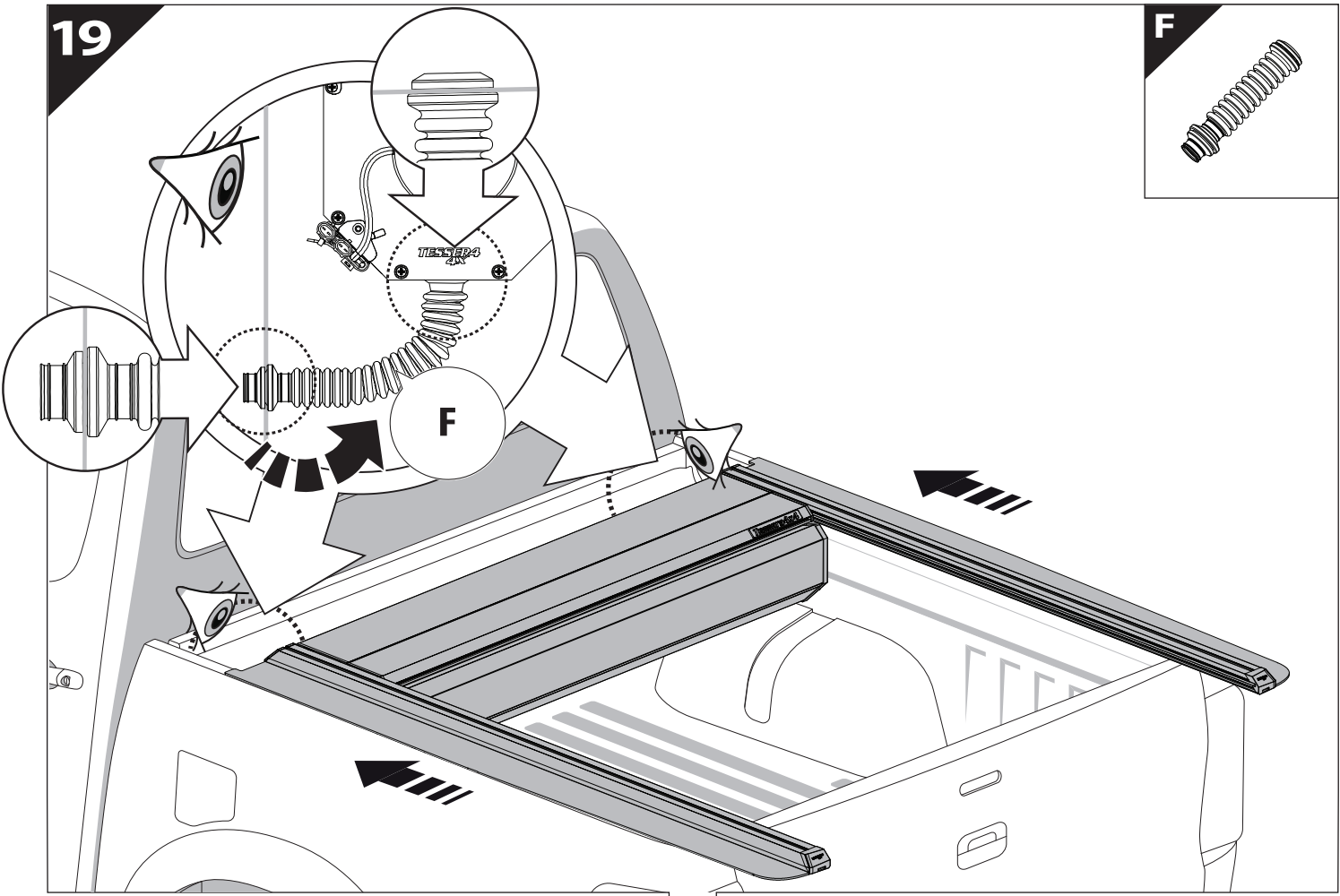

20

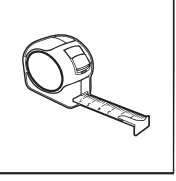
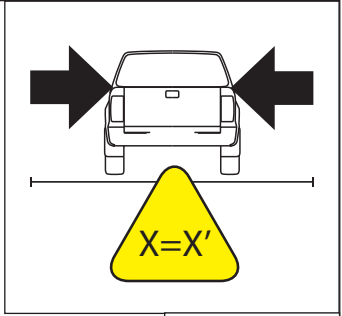
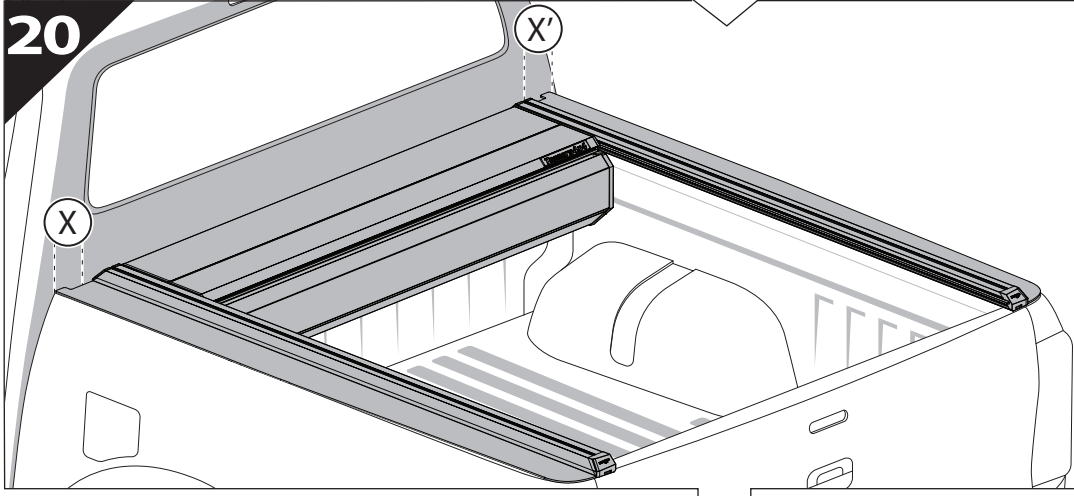

21

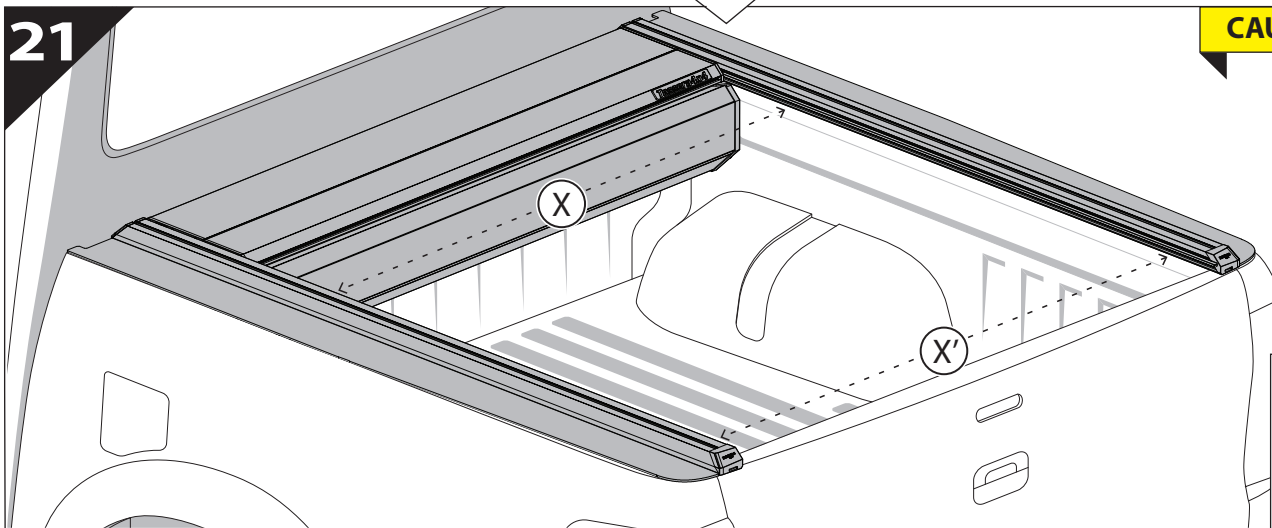

CAUTION !

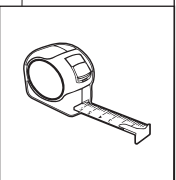
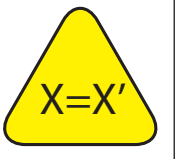

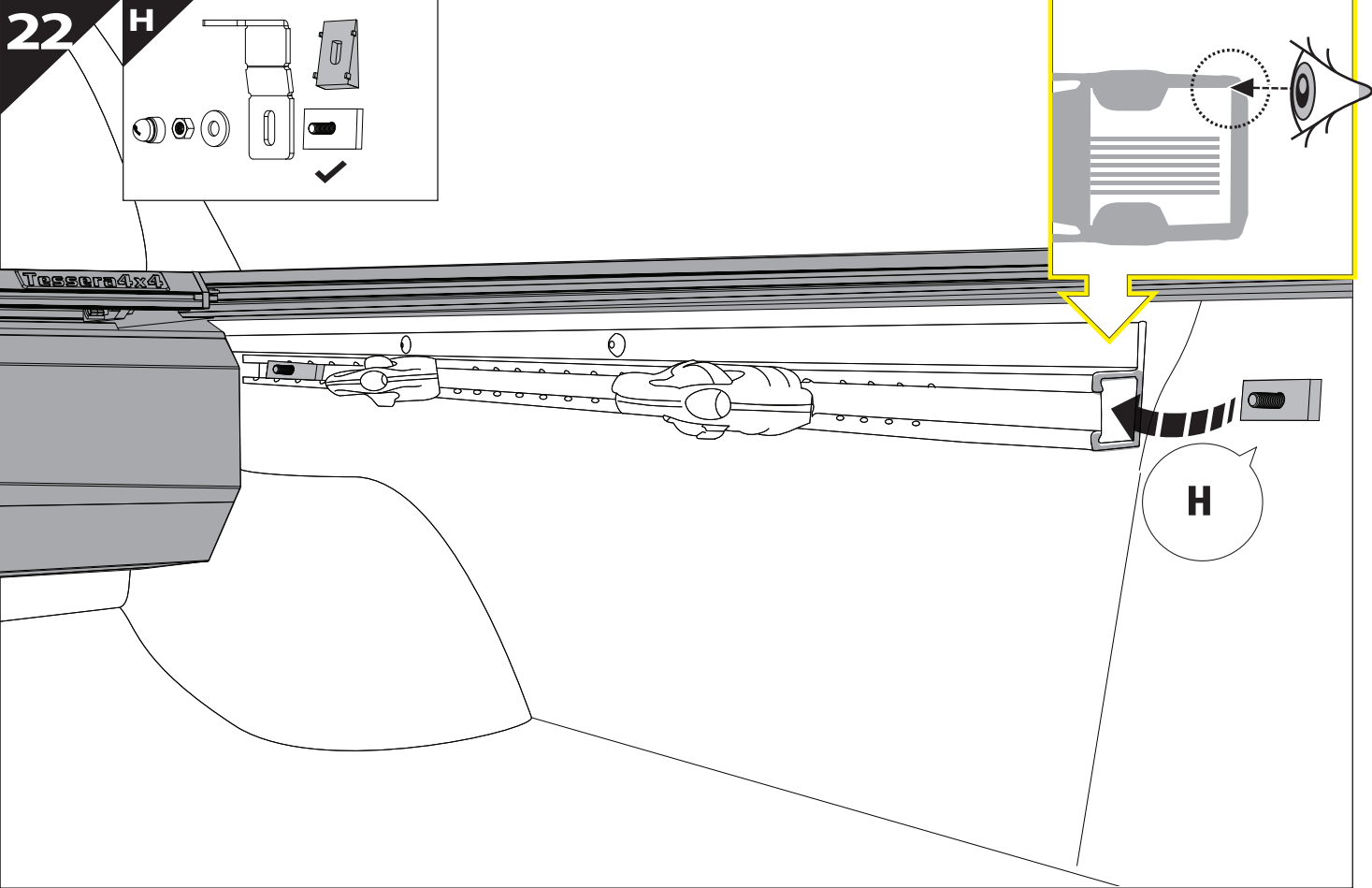

23

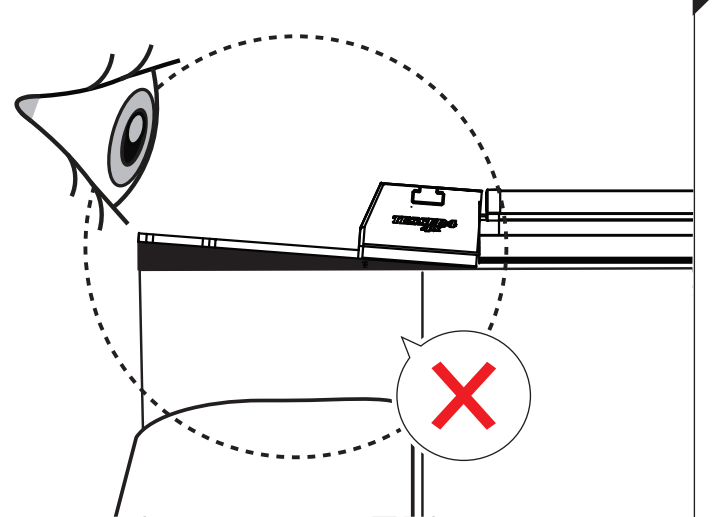
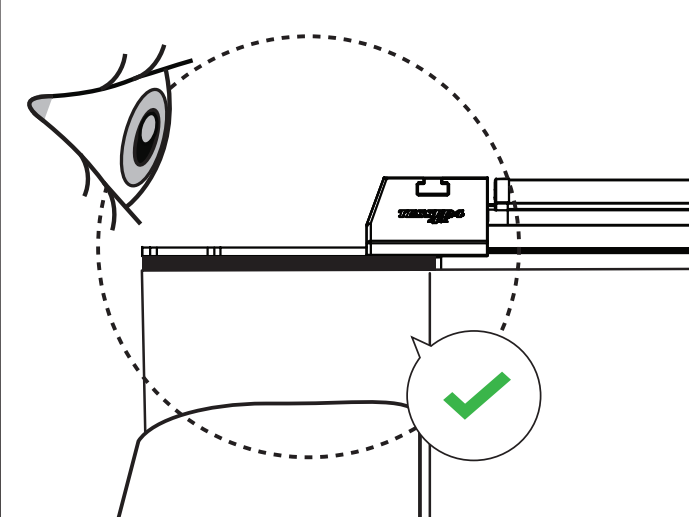
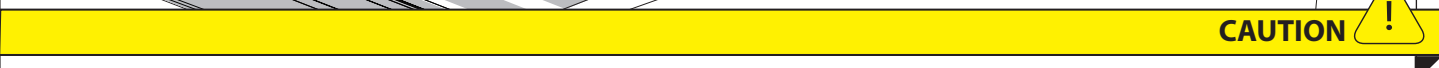
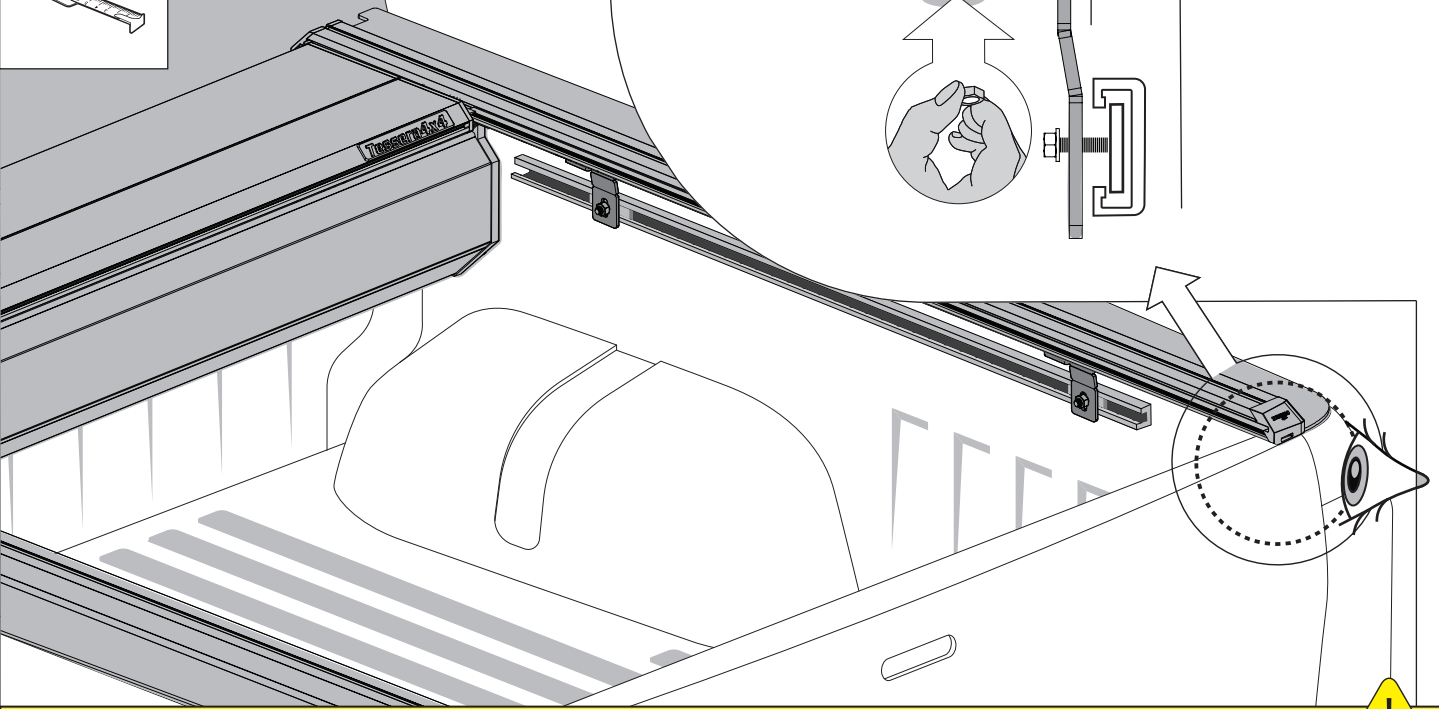
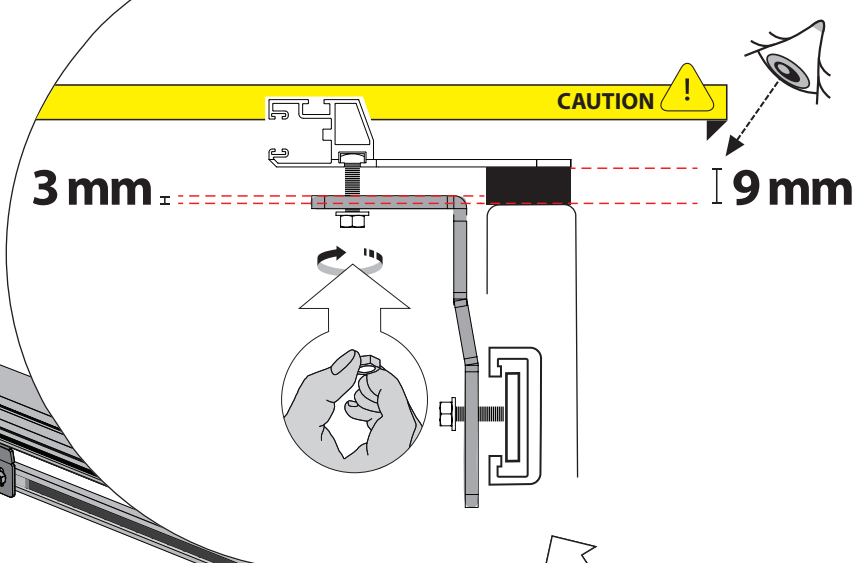
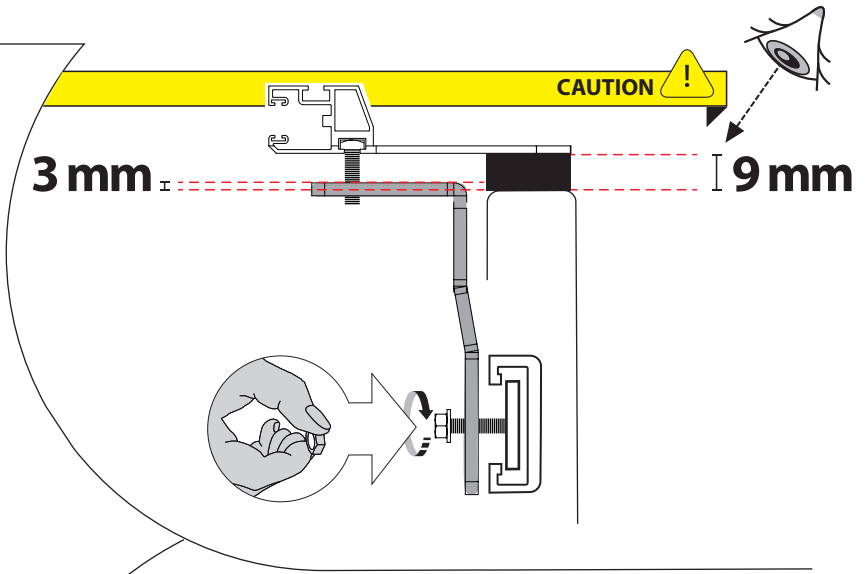
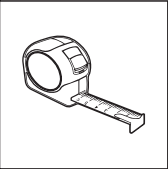
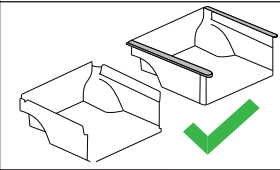
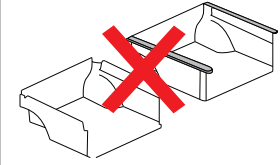
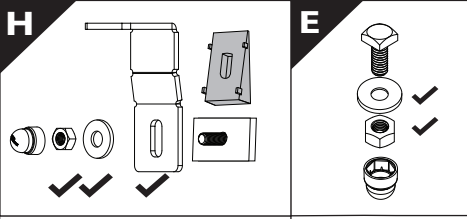

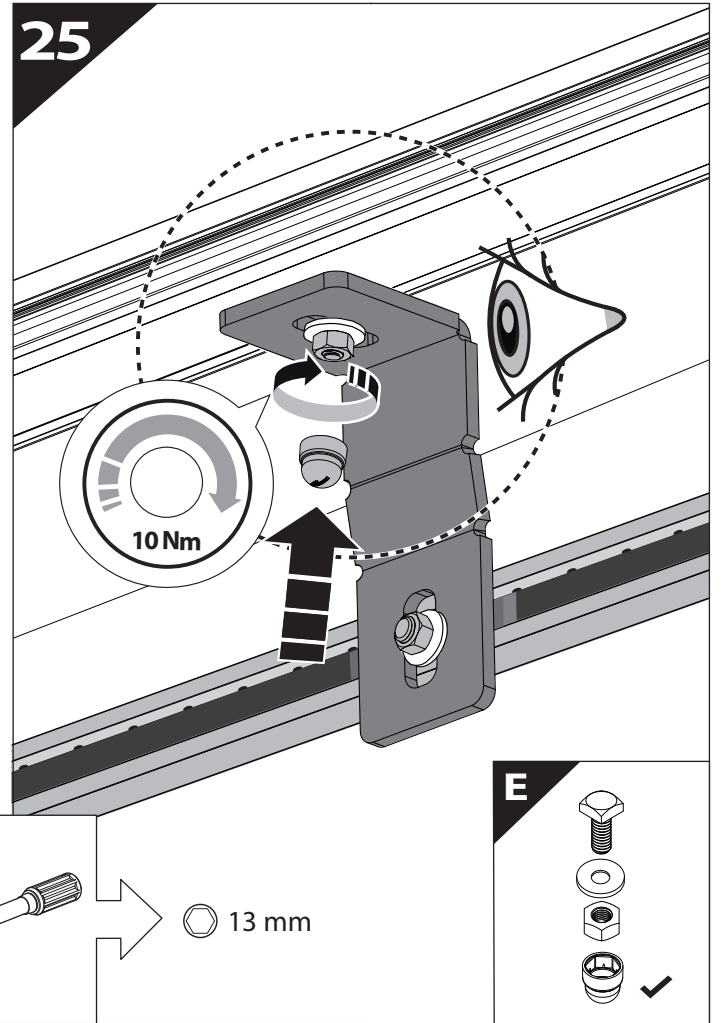
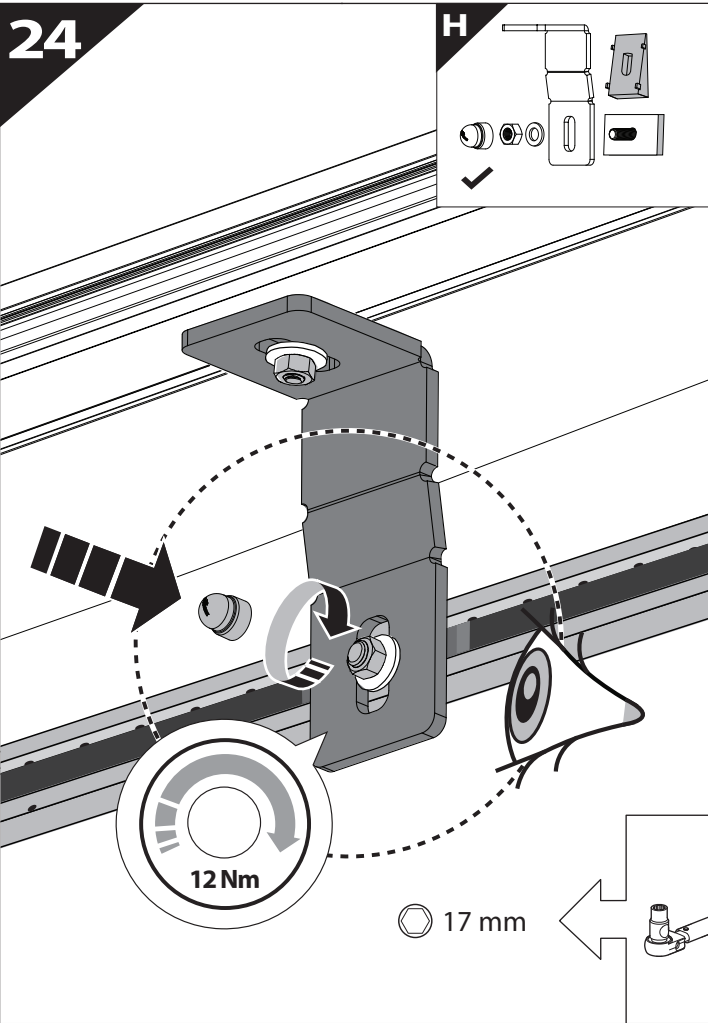

CAUTION !

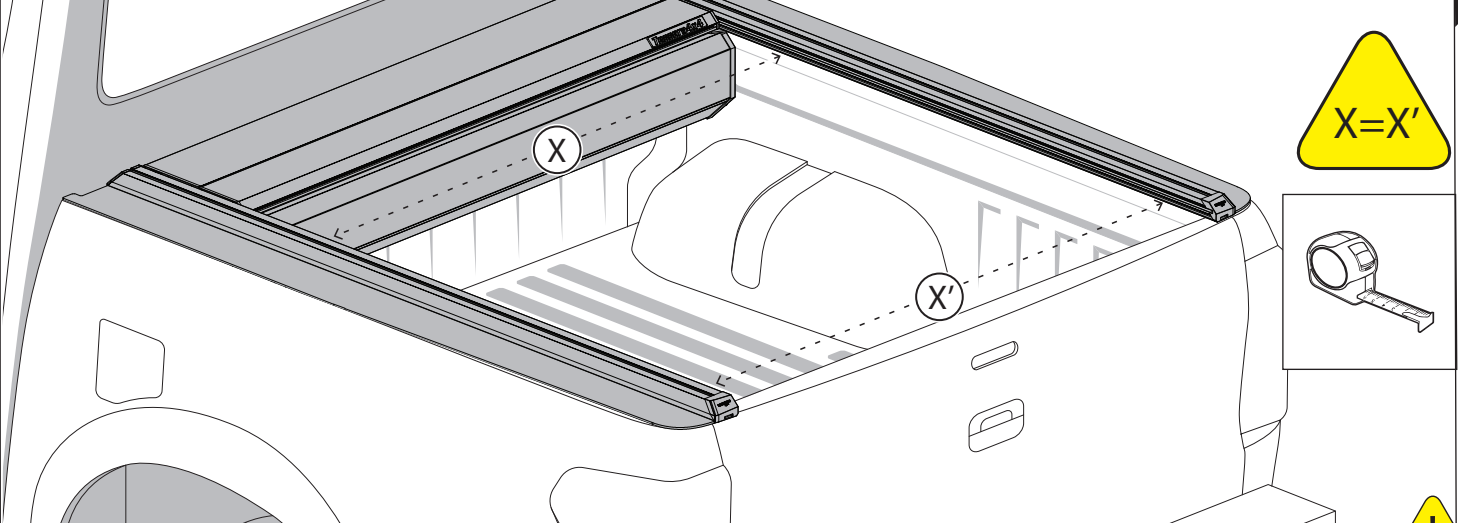

CAUTION !

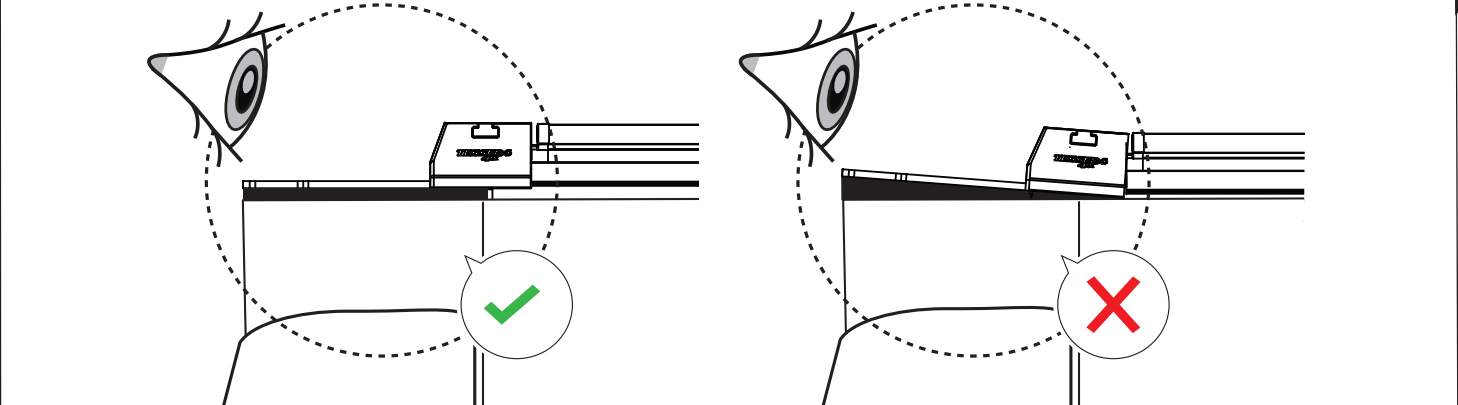

26

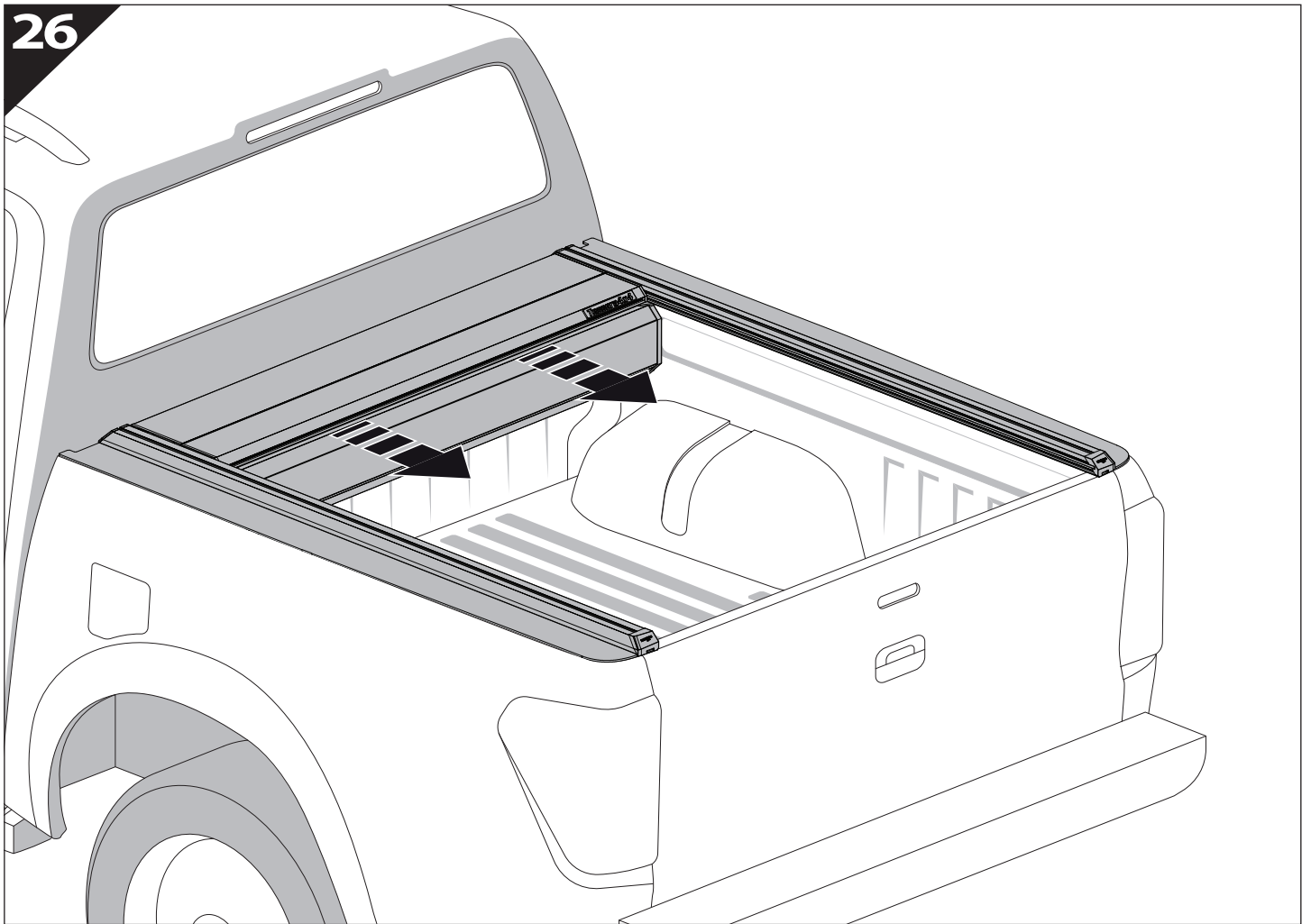

27

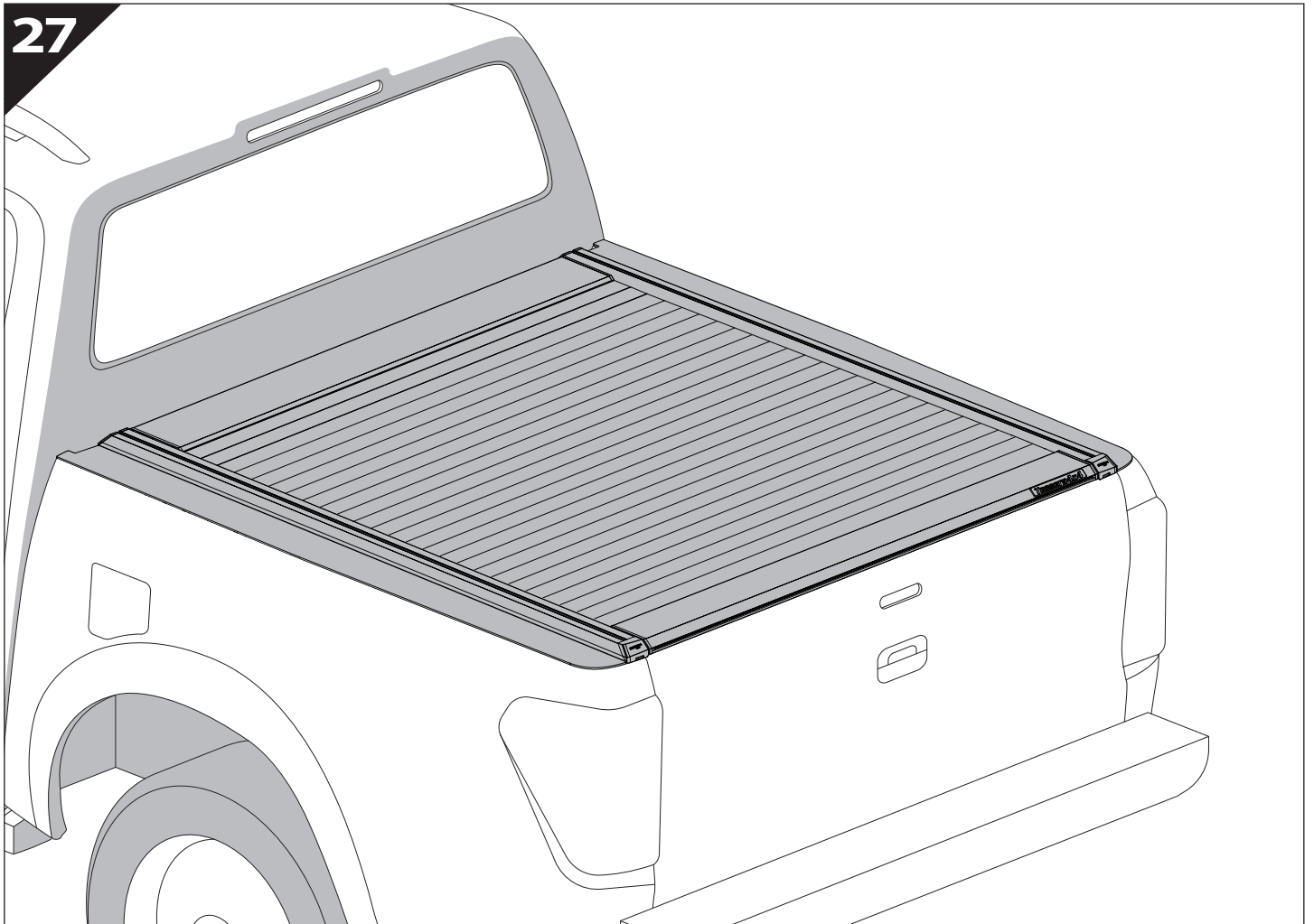



GR: Οδηγίες Εγκατάστασης
GB: Installation manual
SF: Asennusohje
F: Notice de montage
PL: Instrukcja montażu
NL: Installatie-instructies
TR: Montaj Talimatı
S: Monteringsanvisning
E: Instrucciones de montaje

H: Szerelési utasítás
P: Instruções de instalação
RUS: Инструкция по установке
N: Monteringsveiledning
D: Einbauanleitung
CZ: Návod k instalaci
I: Istruzioni de montaggio
DK: Monteringsvejledning
RO: Instructiuni de instalare

Customer Service:

+30 (210) 5541161, +30 (210) 5541154 (08:00 - 16:00 EET)

Support department:

info@gianso.gr

Website:

www.tessera4x4.com

Address:

19.5 km of National road Athens-Korinthos (Elefsina) Greece, P.C: 19200